

TECHNICAL MANUAL ALPINE 2016/17



salomon

TECHNICAL MANUAL ALPINE 2016/17

SALOMON WARRANTY POLICY	3
-------------------------------	---

SKI

Ski length guide	6
Maintenance repairs	8

BINDING

Liability indemnification	12
Preparation	13
Boots to binding compatibilities	14
Mounting	15
MOUNTING BINDINGS, SELECTING THE JIG	15
USING THE JIG	16
DRILLING, TAPPING, GLUE	17
General mounting	18
Adjusting WING / TOE HEIGHT / FORWARD PRESSURE	19
Special cases in mounting & adjusting	
SYNCHRO CENTER AND SYNCHRO RENTAL BINDING	22
SMARTRAK	24
MXT BINDING	25
SMARTRAK GRIP / GRIP PLUS	26
LIGHTRAK PLATE J L & H L	27
X 12 & X 16	28
Z SPEED PLATE	29
EASYTRAK WITH L & C BINDING	30
EASYTRAK WITH LITHIUM BINDING	31
WARDEN 11	33
WARDEN 11 DEMO	35
WARDEN 13 MNC (Multi-Norm Certified) DEMO	37
WARDEN 13 MNC (Multi-Norm Certified) BINDING	39
GUARDIAN MNC (Multi-Norm Certified) BINDING - Backcountry	41
STH2 BINDING « WTR » TECHNOLOGY	45
MTN	47
Release value selection and adjustment	50
Final checking and visual inspection	53
Mechanical inspection	54
Retail - specific instructions	56
Rental - specific instructions	57
Maintenance and repair	61

BOOT

Norm	64
Measurer	65
Liner technologies	66
Women's features	68
Cantable alpine pads	68
Customization	69
Pads	74
Backbone replacement	76
Boot concepts	
X LAB	77
X MAX / X MAX LC / GHOST LC	78
XPRO	80
QST PRO	81
MISSION / DIVINE	83
X PRO and QUEST ACCESS CUSTOM HEAT	85
QUEST ACCESS / QUEST ACCESS T	87
MTN LAB AND MTN EXPLORE MEN & WOMEN	88
GHOST FS	89
SYMBIO	90
Foot anatomy and fit	91

HELMET	96
---------------------	----

GOGGLE	101
---------------------	-----

POLE	110
-------------------	-----

BACK PROTECTION	112
------------------------------	-----

SALOMON LIMITED WARRANTY POLICY

Thank you for buying this SALOMON product.

SALOMON distributes its products through its worldwide network of authorized SALOMON distributors and retailers and on the SALOMON Online Store at the URLs:

www.salomon.com

www.salomonrunning.com

www.salomonfreeski.com

(SALOMON Online Store)

You will find below all SALOMON warranty policy details offered by SALOMON and SALOMON authorized retailers.

This warranty policy is valid as of December 2nd 2015.

I. LIMITED WARRANTY

SALOMON provides this warranty to consumers who purchased SALOMON product (Product(s)) from SALOMON or one of its authorized retailers. SALOMON warrants all new Products to be free from manufacturing or material defects (Defects) for the Warranty Period as defined below. This warranty applies only against Defects discovered within the Warranty Period and extends only to the original purchaser of the Product. SALOMON Products meet their description and specifications; it is your responsibility to ensure that the Products you purchase are designed for your intended use.

This warranty is valid and enforceable only in the country where the Product was purchased by the original purchaser, provided that SALOMON has intended that the Product be offered for sale in that country. This warranty is also enforceable in any country within European Economic Area where SALOMON has an authorized importer, subsidiary or distributor. Please refer to the SALOMON authorized retailers list. Depending on the country, particular and variable warranties may apply in relation to applicable legislation. Nothing in this warranty policy can exclude or limit these statutory provisions.

WARRANTY PERIOD

The Warranty Period starts on the date of the retail purchase of the Product by the original purchaser. The Product may consist of several different parts and different parts may be covered by different Warranty Periods (please

refer to the Warranty Periods below for all warranties that may apply to your Product).

The Warranty Periods are:

- Five (5) years for alpine ski bindings originally purchased prior to October 1, 2011
- Three (3) years for winter sports trousers and jackets
- Two (2) years for all other Products

To the extent permitted by national laws, the Warranty Period will not be extended, renewed or otherwise affected due to subsequent resale, repair or replacement of the Product.

However, part(s) repaired or replacement Product(s) issued during the Warranty Period will be warranted for the remainder of the original Warranty Period only; provided, such replacement or repair has been performed by SALOMON or an authorized SALOMON retailer.

Depending on the country, particular and variable Warranties Periods may apply in relation to applicable legislation. Nothing in this warranty policy can exclude or limit such legislation.

II. CONDITIONS AND RESTRICTIONS

This Limited warranty: does not cover:

- Normal wear and tear of the Product
- Defects caused by the Transportation or storage of the Product
- Defects or damage caused by improper use or poor maintenance
- Damages due to non observance of the instructions of the products owner manual
- Damages due to the modifications of the Product
- Any impact caused by sharp or hard items or objects, due to torsion, compression, a fall, an abnormal impact or other actions not under SALOMON's reasonable control.

This limited warranty is not enforceable if:

- The Product has been modified or repaired by any person or entity other than SALOMON or an authorized SALOMON retailer;
- The Product has been repaired with unauthorized spare parts
- The Product serial number has been removed, deleted, altered or made illegible.

III. WARRANTY ENFORCEMENT

SALOMON or its authorized retailer shall at its sole discretion either (a) repair the Product or (b) replace the Product at no charge. The appropriate remedy will be determined by SALOMON based upon the following considerations: (a) the value of the Product with no Defect, (b) the significance of the Defect, and the inconvenience each remedy would place on the original purchaser. SALOMON agrees that all repair or replacement of the Product will occur within a reasonable period

For all warranty claims, please submit the Product and the proof of purchase to the nearest authorized SALOMON retailer or in the event you purchased the Product on SALOMON Online Store, please contact Customer Service.

For all warranty claims, please refer to the FAQ/ RETURN POLICY available on www.salomon.com

IV. DISCLAIMER AND LIMITATION OF LIABILITY

TO THE MAXIMUM EXTENT PERMITTED BY APPLICABLE MANDATORY LAWS, THIS LIMITED WARRANTY IS YOUR SOLE AND EXCLUSIVE REMEDY AND IS IN LIEU OF ALL OTHER WARRANTIES, EXPRESSED OR IMPLIED. SALOMON SHALL NOT BE LIABLE FOR SPECIAL, INCIDENTAL, PUNITIVE OR CONSEQUENTIAL DAMAGES, INCLUDING BUT NOT LIMITED TO LOSS OF ANTICIPATED BENEFITS, LOSS OF USE, LOSS OF REVENUE, COST OF ANY SUBSTITUTE EQUIPMENT OR FACILITIES, CLAIMS OF THIRD PARTIES, DAMAGE TO PROPERTY RESULTING FROM THE PURCHASE OR USE OF THE PRODUCT OR ARISING FROM THE BREACH OF THE WARRANTY, BREACH OF CONTRACT, NEGLIGENCE, STRICT TORT, OR ANY LEGAL OR EQUITABLE THEORY, EVEN IF SALOMON KNEW OF THE LIKELIHOOD OF SUCH DAMAGES. SALOMON SHALL NOT BE LIABLE FOR DELAY IN RENDERING WARRANTY SERVICE.

BINDING



ALPINE BINDING LIABILITY INDEMNIFICATION

The changes to our 2016-17 Binding Indemnification List reflect Salomon USA's position regarding discontinuation of service on any bindings which are beyond their usable life.

Each year, Salomon USA reviews its Binding Indemnification List.

New models are added, and in some instances, older models are removed from the list.

Older models are dropped to enhance the safety of skiers, and to encourage skiers not to use aged bindings for longer than their reasonably useful life. In summary, skiers are best served when they are

encouraged to stop using bindings that are deemed beyond their usable life by Salomon USA, or bindings which show excessive wear.

SALOMON RETAIL

N Guardian MNC 16	M XT12 / M AM 12	S Z12	C 609	S 914 Pilot	S 710 SC Pilot
N Guardian MNC 13	M XT12 Ti	N Z10 FIS 20	C 608 FIS 17	S 914 FIS Pilot	S 710 Pilot
	M XT10	J Z10	C 608 CP2	S 912 Ti Pilot	S 710 PA
N MTN	M XT10 Ti / M AM 10 Ti	J Z12	C 608 CP	S 912 Ti PaE2	S 710 DP
		J L10	C 608	S 912 Ti	S 710 CP2
N Warden MNC 13	K Z12 Smartrak / K MC 12	E L7 Easytrak	C 607	S 912 PS	S 710 CP
NR Warden MNC 13 Demo	K Z12 Ti Smartrak / K MC 12 Ti	J L10 Junior	C 305 MINI GROM	S 912 FIS Pilot	S 710 CP
D Warden MNC 13 Demo	K Z10 Smartrak / K MC 10	N L9 / N L9W	C 305 MINI	S 912 FIS 24	S 710
F Warden 11 Demo	K Z10 Ti Smartrak / K MC 10 Ti	N TZ5	C 305 GROM	S 912 FIS	C 610 CP2
NR Warden 11 Demo		N T5	C 305	S 912	C 610 CP
N Warden 11	N Z 10 Ti W	E C5 / E Ezytrak 5	920 Equipe Race	S 910 T FIS 26,3/24/20	S 914 PE2
	N Z10		916 Equipe Comp	S 910 FIS 24	S 914 FIS
	N L10	Z 920 Lab	914 FIS	S 810 Ti SC Pilot	S 914 Axe+
N STH2 WTR 16	E Lithium 10	Z 916 Lab	914 FIS 20	S 810 Ti PS	S 914
N STH2 WTR 13	E Lithium 10 W	Z 914 Lab	710 Smartrak	S 810 Ti Pilot	S 910 T PS
	N L7	Z 11	Grip	S 810 Ti Axe+	S 910 T Axe+
	N C5	Z 10 Ti Axe +	610 CP	S 810 Ti	S 910 T
X 20		S 914 Lab	609 D+	S 810 PS	S 910
X 19	N Guardian WTR 16	S 914 FIS 26.3/20/17	914	S 810 Pilot	S 812 PA
X 16	N Guardian WTR 13	S 305 GROM	711	S 810 CP	S 811 PS
X 12	N STH 16 Steel	LZ 9	710	S 810	S 608 CP
	N STH 16 Driver	LZ 8	610	S 711 PS	C509 D+
N Z12 Speed	N STH 14 Driver	LZ 7	609	S 711 PA	C 509 Dr+
N Z12 Speed Ti / N SP12 Ti	N STH 14	L 9 W	608	S 711 CP	C 509
N Z12 Ti Smartrak	N STH 12 Driver	L 9	607	S 710 Ti Pilot	
N Z12 Ti	N STH 12 Oversized	C 610	305	S 710 Ti CP2	
N Z12	N STH 10	C 609 Ti		S 710 Ti	
S Z12 Speed	N Z14 Speed	C 609 D+			

SALOMON RENTAL

NR Z 12 SC	K Z12 Smartrak	NR TZ5 SC / T5 SR /	C 608 SR	305 SR	S 300 SC
NR Z 10 SC	K Z10 Smartrak	T5 SC	C 608 SC	305 SC	Q 500 SR
NR L10 SC	NR L8 SC		C 607 SR		Q 500 SC Drive Plus
NR L10 SR	NR L7 SR	S 305 SC	C 607 SC	S 912 Ti SC Pilot	Q 500 SC
NR L10 Easytrak	NR L9 W SC	S 305 Grom SC	C 305 SR	S 912 Ti SC	Q 400 SR
E Ezy 7 Easytrak	NR L9 W Easytrak	Q 3 SR	C 305 Grom SR	S 810 Ti SC	Q 300 SR
NR L7 Easytrak	NR L7 SR	Q 3 SC	710 SC	Cosmic S 712 SC	Q 300 SC
E L10 Easytrak	NR L7 SC	Cosmic S 710 SR	609 SR	711 SC	C 509 SR
E Lithium 10 Easytrak	NR Z12 Ti SC	Cosmic S 710 SC	609 SC	S 700 SR	C 509 SC
NR C5 Easytrak	NR TZ5 SR	Cosmic S 710	608 SC	S 700 SC Drive Plus	
E Ezy 5 Easytrak	NR TZ5 Junior Trak	C 609 SC	607 SR	S 700 SC	

SCOTT RETAIL AND RENTAL

N Warden MNC 13	NR Warden MNC 13 demo	N BC 13	N S12	N S10
N Warden 11	NR Warden 11 demo	N S14	NR S12 SC	NR S10

TECNO PRO RETAIL AND RENTAL

KR TX 120	E LT 100	KR TX110	TL 100 ET	TL 75 SC
N TL 75	E LT 100W	N TL 100 CP	N TL 90	TL 75 ET
N TC 45	E TC 45	N TL 100	N TL 90 W	TC 45 SR
E TL 75		N TL 100 SC	N TL 90 CP W	TC 45 ET

HOW TO READ THE LIST

Current Line

Final season

PREPARATION

Proper procedures for a certified technician to follow while mounting and adjusting Salomon Bindings. Therefore, rental bindings can be shipped without instructions or individual packaging. However, if these products are in fact sold, you absolutely have to supply your customer with the appropriate instructions. Upon request, Salomon will supply you with a document containing important information. The seven important steps to installing and adjusting are :

1. Preparation
2. Installation
3. Binding-to-boot adjustment
4. Release value selection and adjustment
5. Final check and system inspection
6. Mechanical inspection
7. Skier instruction and Warning

LIST OF TOOLS AND ACCESSORIES THAT ARE NECESSARY IN THE WORKSHOP

- › Technical manuals for Skis and Bindings
- › Spare-parts catalogs
- › Release adjustment table (DIN chart) + skier type
- › Jigs (please consult spare-parts catalog for different references)
- › Synchro measuring device ref. 001189
- › Electric drill
- › Drill bits (see on spare-parts catalog for different models)
- › Adjustment tool (Salomon screwdriver) ref. 000902
- › Power screwdriver with torque release
- › Posidrive® screwdriver 7mm - ref. 000862
- › Tap ref. 000816
- › Brace ref. 000817
- › Repair kit (2 extractor bits and repair plugs) ref. 000878
- › Grease ref. 000905
- › Glue ref. 000811
- › 4.5 diameter plastic plugs (different references depending on the color - see spare-parts catalog)
- › Specific adaptations: (for the references see spare-parts catalog)

Brakes

- carving (=long arms)
- wide brake

Plates

- › For all other parts (such as AFD, housing, brakes, crews...), please consult your spare parts catalog.

BOOT TO BINDING COMPATIBILITY

Before drilling the ski, be sure the boot you are using is compatible with the binding. Only boots that conform with applicable standards may be used with Salomon bindings. If a boot sole is warped, worn or improperly canted, such that there is more than a 1 mm difference in sole flatness measured across its width, the boot is incompatible.

OTHER COMPATIBILITY PROBLEMS YOU MAY ENCOUNTER:

- Cut-outs in the boot sole that prevent the brake from engaging properly.
- Excessive ramping or wear of the boot sole at the point where it contacts the binding. Any wear that inhibits binding function is excessive.
- Tread, grid pattern or insignia present in the AFD area of the boot sole. This area must be flat over its entire surface.
- Non-compatible boot sole composition. Low-grade thermoplastic (T.P.) boots may not be used with Salomon bindings. If you are uncertain as to the quality of the boot sole material, perform the Clean vs. Lubricated Test.

Only adult norm boots may be used with adult bindings. Under no circumstances should a children norm boot ever be used with an adult binding. The following bindings can be used with both children and adult norm boot soles: Salomon L7, Salomon C5, earlier model equivalents, and their various retail and rental counter parts. The added width of an adult norm boot sole somewhat limits the shock absorption capability

of these models and they should not be used with a boot sole longer than 304 mm. As a result, it is recommended that an aggressive junior skier with an adult norm boot sole use a model designed exclusively for adult norm boots.

A Salomon toe or heel may not be mounted with another manufacturer's toe or heel. Warranty is automatically voided for such mixed systems.

CHILDREN BOOT TO BINDING COMPATIBILITY CHART

SALOMON Boots Models	Children* Norm Boot Soles	Adult Norm Boot Soles
X Max LC		22 - 27.5
Quest Access 70T		22 - 27.5
T3 / T3 RT / Team T3		22 - 26.5
X3 60 T	18 - 21	22 - 26.5
X-Max 60 T	18 - 21	22 - 26.5
Team	18 - 21	22 - 26.5
T2 / T2 RT / Team T2	18 - 21	
T1	15 - 18	

*Boots with Children Norm Boot Soles should only be used with Junior Norm Bindings.

BOOTS & BINDING COMPATIBILITIES

WHAT MEANS THE LABEL WTR AND MNC ON A BINDING ?

ALPINE BOOT

All alpine boots certified
DIN/ISO 5355



BOOT WITH WTR / WTR+ TECHNOLOGY WALKING SOLE PADS

WTR+: with insert
compliant with
DIN/ISO 9523



TOURING BOOT

All touring boots
compliant with
DIN/ISO 9523



NOT NORM

Touring boots
not compliant
with DIN/ISO
9523 standard



ALL ALPINE BINDINGS

CERTIFIED BY
DIN/ISO 9462



ALL BINDINGS STAMPED WITH



CERTIFIED BY



CONCERNED BINDINGS:

STH² WTR & GUARDIAN WTR (range 2012-2013)

DIN/ISO
9462 & 13992

ALL BINDINGS STAMPED WITH



CONCERNED BINDINGS:

WARDEN MNC, WARDEN MNC DEMO and GUARDIAN MNC

CERTIFIED BY
DIN/ISO 9462 & 13992



BINDING WITH PIN

CONCERNED BINDINGS: MTN

NOT
CERTIFIED BY



MOUNTING

MOUNTING BINDINGS

1. Remove shrink wrap from skis.
2. Drill the skis using the appropriate jig and drill bit as shown in the **chart opposite**. Make sure that the jig is parallel to the ski during the entire drilling process (**fig.1**).
3. Follow the ski and binding manufacturers' mounting instructions closely.
It is necessary to use Salomon glue or Epoxy.

Operation	All models except:	X-RACE JR, ROCKER ² JR, NFX JR, QST MAX JR, QST LUX JR	
		ski G3 - G4	ski G1 - G2
Ø of drill bit	4,1 mm	3,6 mm	4,1 mm
Tapping	No	No	
Glue (put the glue at the bottom of the hole)	Salomon glue or epoxy	No glue	
Torque	4 Nm	3 Nm For these skis, use a hand screwdriver only to tighten the screws on the bindings.	



SELECTING THE JIG

SYNCHRO CENTER AND SYNCHRO RENTAL BINDING

Ref.	Jigs	Skis Widths	Application
001003	Rental Line Senior and Junior	56 mm ↔ 99 mm	Synchro Center Adult - Synchro Rental Adult (Lenght drilling 9,5 mm) Z 12 - 10 SC L 9 - 10 SC & SR L 7 SC (Lenght drilling 8 mm) L 7 SR
001040		80 mm ↔ 123 mm	Synchro Center Junior - Synchro Rental Junior (Lenght drilling 8 mm) T 5 SC - T 5 SR - C 5 SR

SYNCHRO RENTAL JIG 001003

A single mounting jig for Adult and Junior skis with the following positions:
Adults (sizes 22-34) for skis > 140 cm.
Junior (sizes 16-26.5) for skis 80-140 cm.

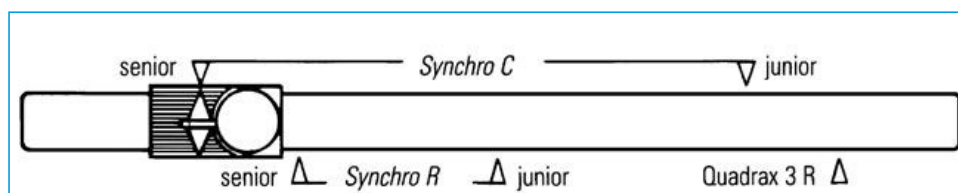

RENTAL BINDINGS					
JIGS POSITIONS 001003 & 001040	Z12 SC Z10 SC L10 SC L9 SC L7 SC	L10 SR	L7 SR	T5 SC	C5 SR
Synchro C Senior	•				
Synchro R Senior		•			
Synchro C Junior				•	
Synchro R Junior			•		
Quadrax 3 R					•
Soles Lenght	260 mm ↔ 382 mm	268 mm ↔ 348 mm	230 mm ↔ 308 mm	216 mm ↔ 304 mm	190 mm ↔ 246 mm

BINDING INSTALLATION

>>>

ALL OTHER BINDINGS

Ref.	Jigs	Skis Widths	Application
78406101	Junior	56 mm ↔ 99 mm	Junior (Length drilling 8 mm) T 5 - C 5
24729001	Junior	56 mm ↔ 99 mm	Junior (Length drilling 8 mm) TZ 5 Juniortrak
001156	Adult Line Senior	56 mm ↔ 99 mm	Senior (Length drilling 9,5 mm) STH 16 - 14 - 12 Driver . STH 12 Z 14 - 12 - 11 - 10 L 10 - 9
001157		80 mm ↔ 123 mm	Junior (Length drilling 8 mm) L 7
78840301	SMARTRAK	70 mm ↔ 116 mm	Senior (Length drilling 9.5 mm)
30863001	Easytrak	70 > 116 mm	Senior (Length drilling 9.5 mm)
32670501	Backcountry	56 > 143 mm	Senior (Length drilling 9.5 mm)
32981601	STH ² WARDEN 13 MNC	56 > 143 mm	Senior (Length drilling 9.5 mm)
39109101	WARDEN 11 WARDEN 11 DEMO WARDEN DEMO 13 MNC	56 > 143 mm	Senior (Length drilling 9.5 mm)
37818901	X Track plates	56 > 143 mm	Senior (Length drilling 9.5 mm)
38162501	MTN	56 > 143 mm	Senior (Length drilling 9.5 mm)
11847301	X bindings	60 mm ↔ 86 mm	Senior (Length drilling 9.5 mm) X 20 - 18 - 16 - 12

USING THE JIG

The main function of a jig is to insure that all holes for mounting the binding are drilled in the correct location.

See chart to select the proper jig.

1. Check that you have everything you need (the jig that corresponds to the binding, the right skis, the right boots).
2. Open the locking lever.
3. Open the jig by twisting both handles inward.
Place the jig in the right direction on the ski.
4. Place the jig on the ski and make sure that the jig remains properly aligned to the ski during the entire drilling operation (fig.1).
 - If the ski has a mid-sole mark, line up the mid-sole indicator on the jig with the mid-sole mark on the ski (fig.2).
 - If the ski has a tip-of-the-boot mark, line up the tip-of-boot-sole indicator on the jig with the tip-of-boot mark on the ski.
 - If the ski has no visible markings for jig location, consult the ski manufacturer for proper mounting position.
5. Once the jig is well-positioned on the ski, it is important to adjust the jig to the correct boot length to make sure the heel piece is in the proper position.
6. Place the boot on the jig in the right direction.
7. Make sure the heel guide fits snugly against the boot heel.
8. Using the lever, lock the jig around the boot so it holds it without squeezing.

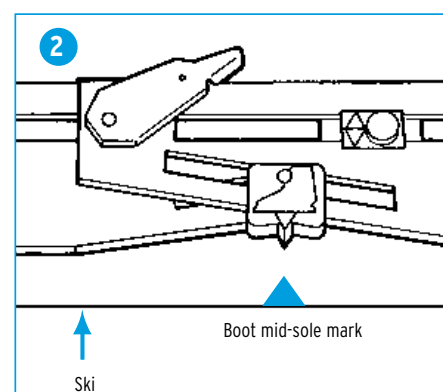
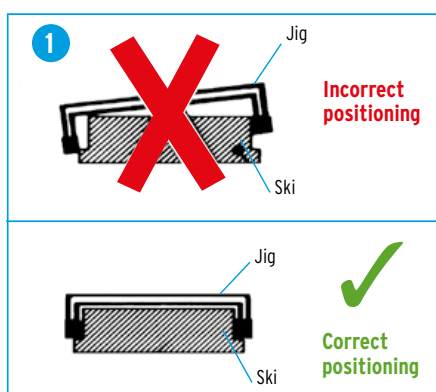

FAT SKIS

Refer to the spare parts catalog to know which jigs and brakes to use according the different ski widths and binding models.

The reversible pads allow the jig to adapt to different ski widths (fig. 3).

Procedure for changing the pads to the other side:

1. Pull the pad off the arm of the jig.
2. Change the pad to the desired position.
3. Insert the pad into the arm of the jig.
4. Repeat this procedure:
 - On the other 3 arms for mounting the bindings symmetrically.

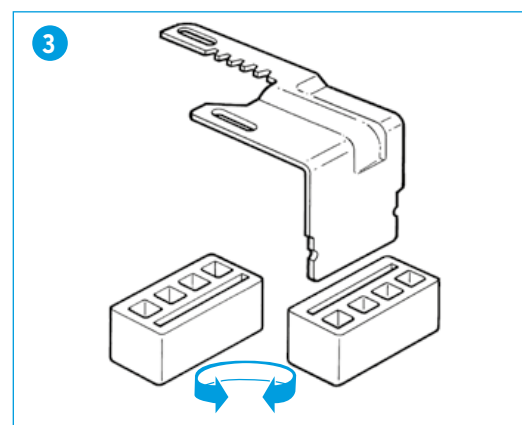



DRILLING

1. Follow the recommendations of the ski manufacturer for drilling and tapping.
When in doubt about the ski's core composition, select a 3.6 mm diameter bit, and drill one hole to see if any metal comes in contact with the bit. If contact is made with metal, re-drill with a 4.1 mm bit.
2. Drill through the jig's proper bushings applying moderate downward pressure on the drill.
Make sure that the countersink bevel on the drill bit has properly deburred the hole.
3. After drilling, turn the ski over and hit the base several times with the palm of your hand to remove any debris from the drilled holes.

DRILLING JUNIOR SKIS

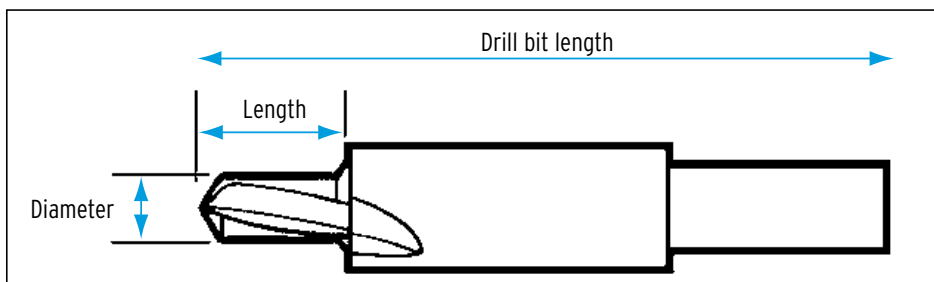
- Use an 8 mm length drill bit to mount the Junior bindings L 7 - L 7 SR - T 5 - T 5 SC & SR - C 5 - C 5 SR - Easytrak L7 & C5.
- Whenever junior bindings are mounted on adult skis, there is an increased possibility for binding pull-out due to poor screw retention. The penetration depth of junior screws into the ski core is only 6 mm.
If necessary, use adult screws and drill bits to penetrate any mounting platform.
(For bindings mounted with adult binding screws, the penetration depth is the same.)
- You must drill a hole deep enough to accommodate the screw length you are using or damage to the ski base may result.

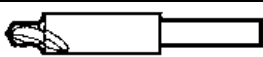

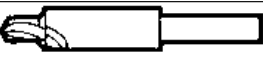
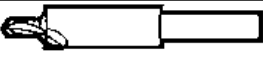
Skis	Diameter	Length	Reference	Aspect
Junior Ski Group 3 & 4	4,1 mm	8 mm	000813	
	3,6 mm	8 mm	000814	
Adult Ski Group 1 & 2	4,1 mm	9,5 mm	000893	
	3,6 mm	9,5 mm	000892	

TAPPING

Tapping is usually done when the binding screw will come into contact with metal or in the following cases:

- the material is too hard for a screw,
 - when the screw insertion would distort or stress the material holding the screw,
 - when recommended by the ski manufacturer.
- Failing to tap when necessary can result in top skin or sidewall delamination, broken screws or damage to the ski core.

To use a Salomon tap and brace:

1. Position the brace so that the tap goes straight into the drilled hole.
2. Apply only enough pressure on the brace to start the tap. The tap is a self-cutting tool and you have only to turn the brace for the tap to cut its own way into the core.
3. Make 3 1/2 turns.
4. After tapping, turn the ski over and hit the base several times with the palm of your hand to remove any shavings from the hole.

GLUE

Glue must be used when inserting binding screws to:

- lubricate the screw during insertion,
 - create a watertight seal.
- Place a drop of glue on the surface of each hole.

Caution: Salomon strongly recommends its own glue for Salomon skis.

MOUNTING

Follow the mounting procedure and also refer to the section "Special cases in mounting".
A Posidrive® n°3 screwdriver, not a Phillips, must be used to mount Salomon bindings. Consult the Salomon Spare Parts Catalog for reference on Salomon screws.

Caution: if a power screwdriver is used, adjust the clutch for the appropriate ski core construction (4 Nm maximum) to avoid stripping the threads.

It is advisable to hand check each screw after mounting.

GENERAL MOUNTING

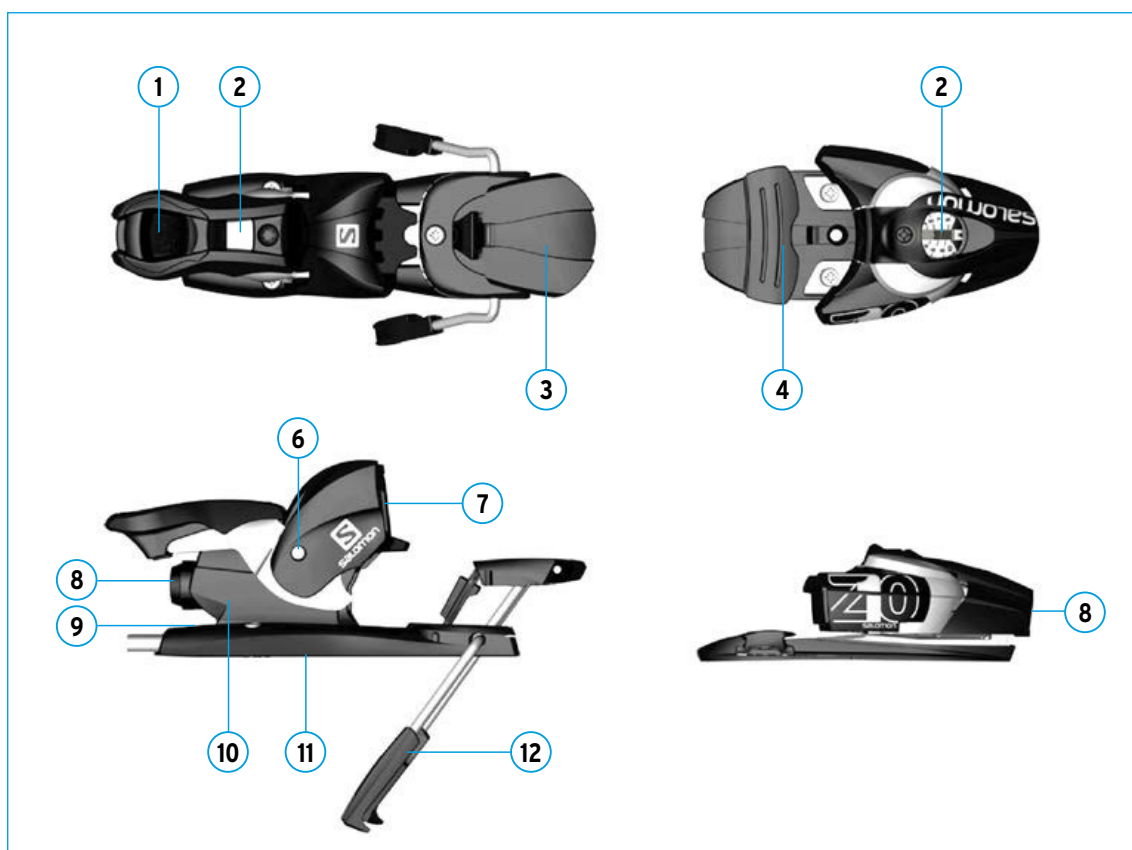
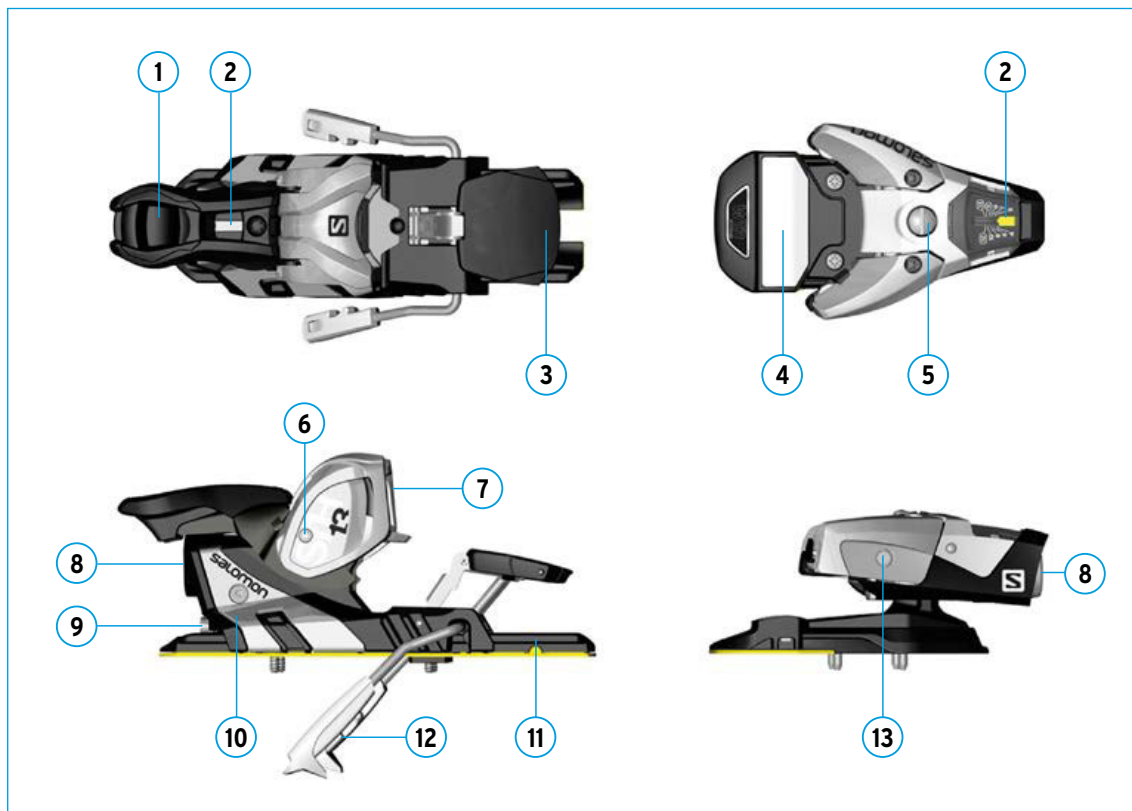

ADJUSTING

Once the binding has been mounted, it is necessary to make the proper binding-to-boot adjustments. All Salomon bindings may be closed manually by simply lifting the heel lever. Adjustments must be re-checked every time boots are changed. Use the following procedure.

WING ADJUSTMENT

1. Manual adjustment (fig. A1): only one adjustment screw, which is located on the left side of the toe piece.

- Place the boot in the binding (closed position).
- Loosen the micrometric screws to loosen the wings.
- Check that the tip of the boot sole is flush against the butt plate (fig. A2). This contact is made when the boot has lateral play. Do not over tighten, the boot may no longer be centered.

2. Automatic adjustment: the wings on the toe cup are self-adjusting.

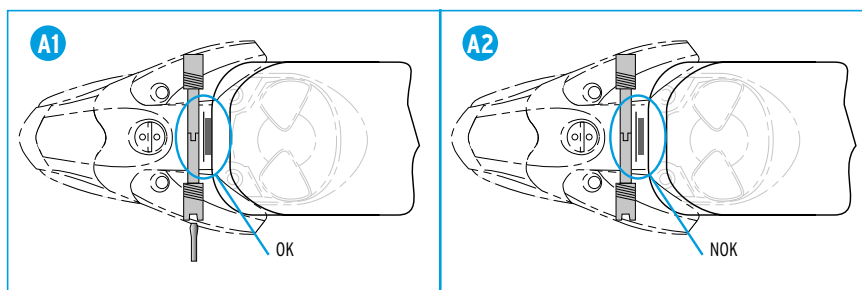

TOE HEIGHT ADJUSTMENT

- With the boot in the binding, raise the toe by turning the adjustment screw, located on top of the toe piece, counter clockwise.
 - Pull the boot back to create a gap between the boot sole and the binding AFD.
 - Lower the toe height by turning the adjustment screw clockwise to obtain the recommended gap (see the following chart (fig. B1-B2)).
 - For models with automatic wing and automatic height adjustments: make forward pressure adjustment only. See instructions in following chapters.
- Note:** Always check the forward pressure after making toe adjustments.

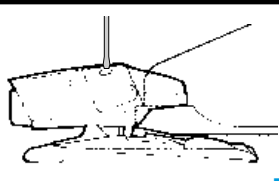
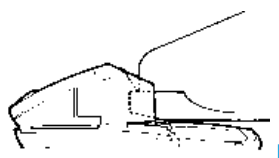
Models		Wing adjustment	Toe height adjustment
Driver 12 to Driver 16 Guardian WTR & MNC 13 & 16 Warden 13 MNC & Warden 13 MNC DEMO Warden 11 & Warden 11 DEMO	 B1	simultaneous	manual 0,5 mm
C 5 To Z 14	 B2	automatic	automatic

FORWARD PRESSURE ADJUSTMENT

WITH TOOL LESS AND TAB ADJUSTMENT

With the boot in the binding (closed position), make sure the arrow. The extremity of the tab for the version without arrow, line up within the scribed area of the heel housing.

If this adjustment is incorrect, remove the boot from the binding, lift the adjustment tab to slide the heel into the desired position. Re-insert the boot to check the adjustment.

XTRACK MXT
WARDEN
DEMO
13 MNC

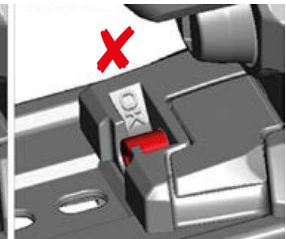
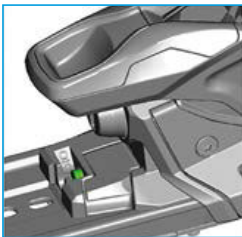

SMARTAK + KZ

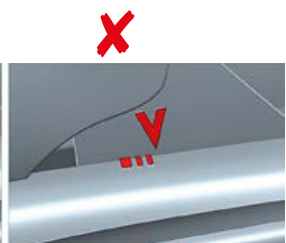
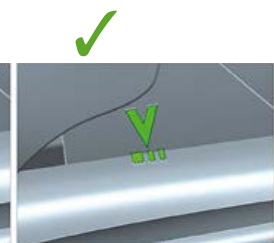
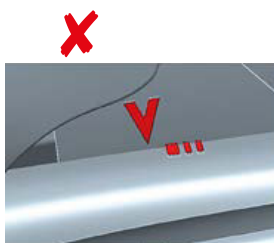

LIGHTRAK
+ JL

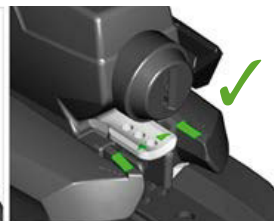
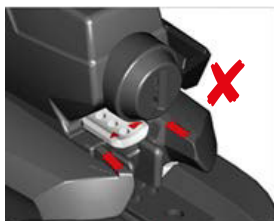

EASYTRAK
WITH
LITHIUM,
WARDEN 11
& DEMO 11

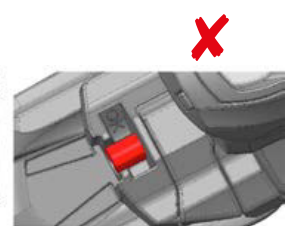
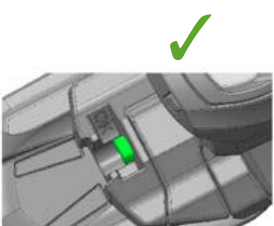

EASYTRAK +
EC5-EL7-EL10

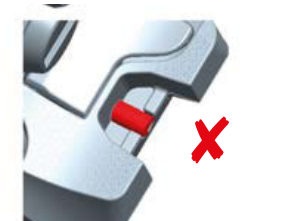

RENTAL SC & SR

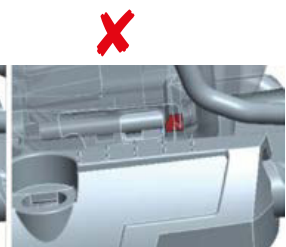
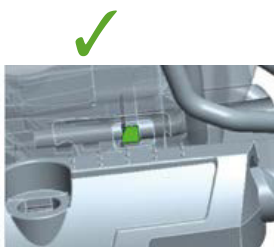
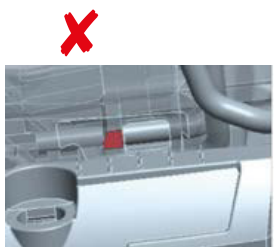

L & Z



JUNIOR BINDING



> WITH SCREW ADJUSTMENT

With the boot in the binding (closed position), adjust the forward pressure to align the top of the head screw with the back of the heel part.

MODEL X16LAB, X12LAB

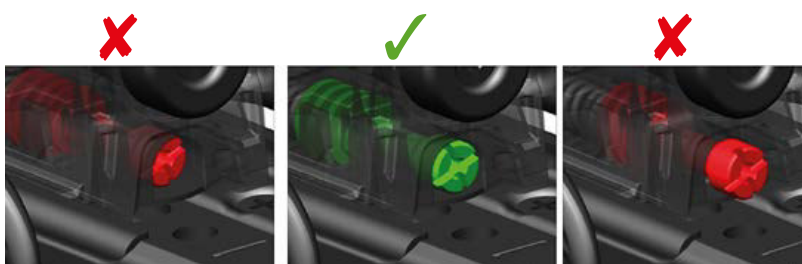

MODEL X19 LAB, X20LAB

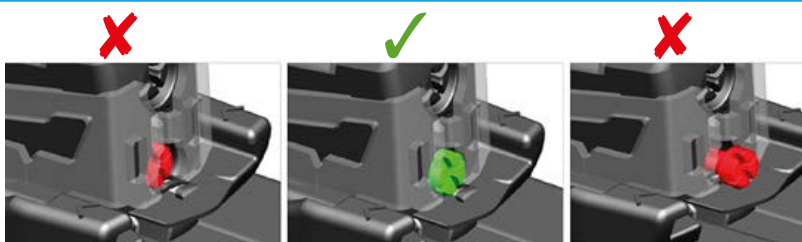

GUARDIAN MNC, WARDEN MNC, STH² WTR



STH

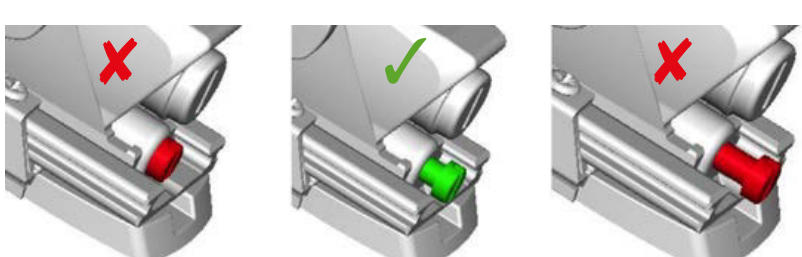
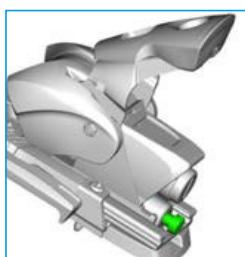

SYNCHRO CENTER AND SYNCHRO RENTAL BINDING

TO BE MOUNTED BY A SALOMON AUTHORIZED DEALER ONLY.

PREPARATION

It is important to maintain consistent procedures when mounting any Salomon binding. Any boot used with a Salomon rental binding must be visually inspected for compatibility.

To use the Synchrosysteme you need:

- Synchrosysteme jig references 001003 and 001040.
- adjustment tool reference 000902.

The bindings that are compatible with the Synchrosysteme are the following:

Z12 SC. Z10 SC. L10 SC. L 9 SC. L10 SR. L7 SC. L7 SR. T5 SC. C5 SR.

The Synchrosysteme can be used with all Alpine boots (DIN, ISO 5355) from all brands. The measuring device can be used if skiers come in the shop with their boots on.

SYNCHRO RENTAL

For mounting Synchro Rental bindings, follow the same procedure as for the retail bindings.

SYNCHRO CENTER

CONTENTS OF THE BOX

- ▶ The heel mounted on a plate,
 - ▶ The toe mounted on a sliding plate,
 - ▶ The position indicator,
 - ▶ The premounted track assembly with yellow screw (Adult skis).
- Caution:** the toes mounted on the sliding plate are specific to RENTAL products.
- ▶ Brake.

1. Position the rental jig (ref. 001003 or 001040 for a fat ski rental) on the ski.

2. Then drill through the jig's proper bushings. Follow the same procedure as for retail bindings (drilling, tapping, glue).

3. Mount the premounted track assembly orienting the sticker toward the back of the ski (**photo. 1**).

4. Mount the heel aligning the holes, and tighten the screws (**photo. 2**).

5. Mount the brake according to the usual procedure.

6. To Position the toe piece:

- Place the toe, mounted on the sliding plate, in front of the track and slide it until it stops.
- Depress the manual adjustment button (located on the front of the toe) and slide the toe all the way back.
- Slide the indicator forward and clip it on the sliding plate (**photo 3**) either manually or with a flat Salomon screwdriver (ref. 000902).

7. To take the toe off the track:

- Place the toe on the A position of the position indicator.
- Unclip the position indicator with a flat Salomon screwdriver (**photo 4**).
- Depress the manual toe adjustment button ; this way, the toe can slide forward off the track.

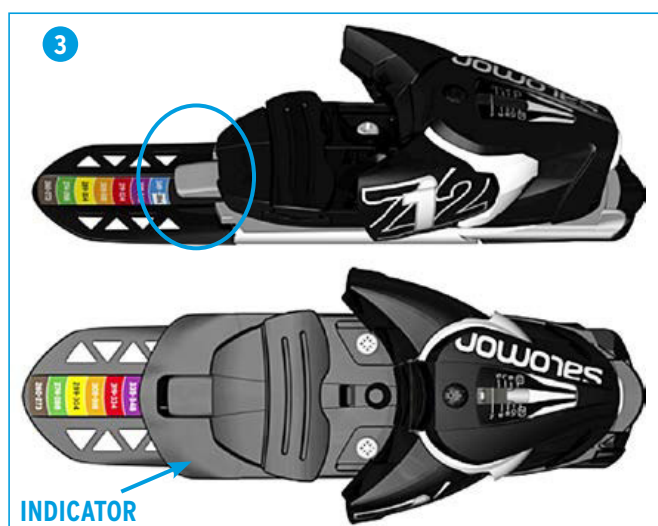
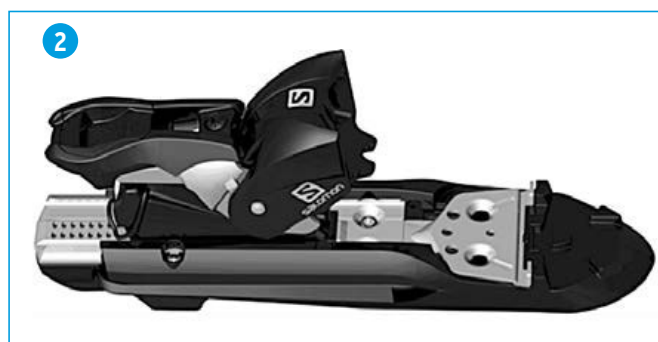
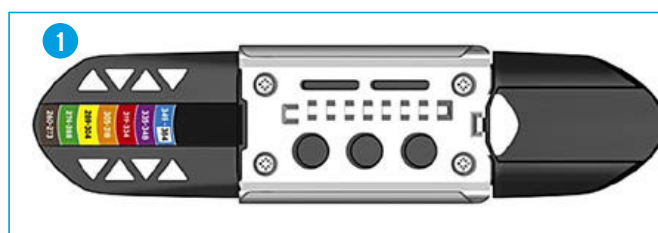

SYNCHRO CENTER

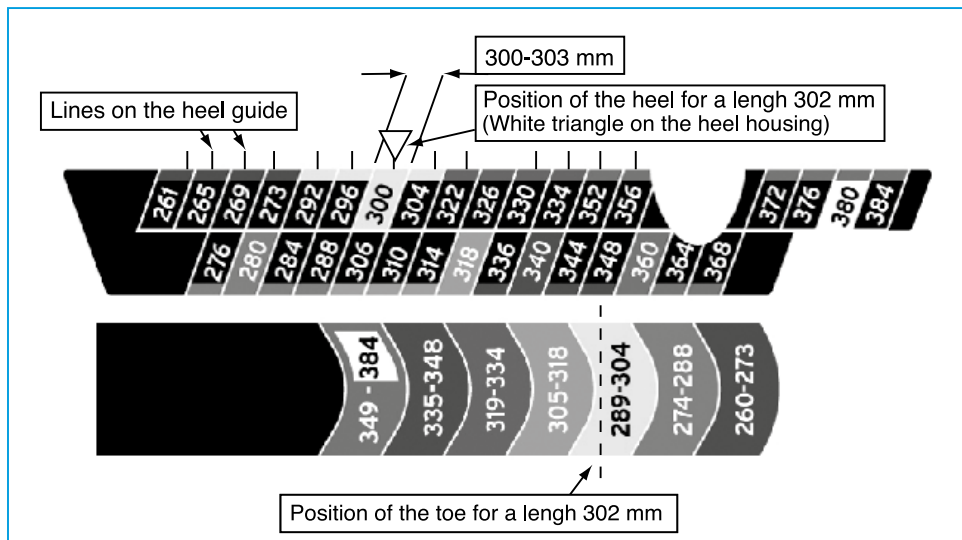

› Binding to boot adjustments without using the Synchrosysteme:

Easy glide manual heel adjustment:

- Position the boot in the toe piece.
- With one finger, simply lift the adjustment loop at the back of the heel and slide it forward until the binding cup contacts the boot heel.
- Release the loop, push boot down and check the forward pressure adjustment.

To do this, you should see a little metal guide in the indicator (fig. 1).

Note: If a correction is necessary, reopen the heel to move it and then re-check.

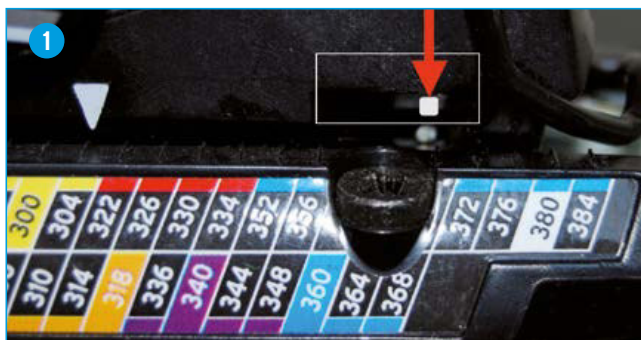

› Release value adjustment:

The bindings must be adjusted by using the Adjustment chart.

› Visual and mechanical inspection:

Whenever a binding looks particularly dirty or if visual inspection reveals that something may be wrong with the system, the system should be cleaned, lubricated and subjected to mechanical inspection.

SMARTRAK

TO BE MOUNTED BY A SALOMON AUTHORIZED DEALER ONLY.

CONTENTS OF THE BOX

- › 2 Toes mounted on a sliding part
- › 2 Heels mounted on a sliding part
- › 2 Brakes
- › 2 Thin Plates
- › 1 Notice



MOUNTING

1. Insert the Thin Plate in the seating ahead the plate (fig. 1).
2. Place it correctly with a rotational motion (fig. 2).
3. From the rear, slide the Toe piece on the interface until it corresponds with or is just above your boot sole length using the manual lock to authorize the sliding (fig. 3 & 4).
4. From the rear, slide the Heel piece on the interface until it corresponds with or is just above your boot sole length using the manual lock to authorize the sliding (fig. 5).
5. Mount the Brake following the usual procedure (fig. 6).

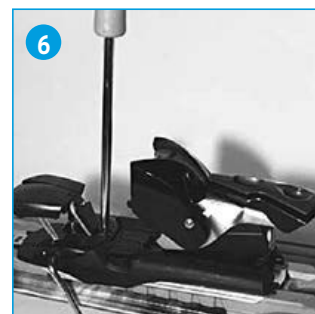
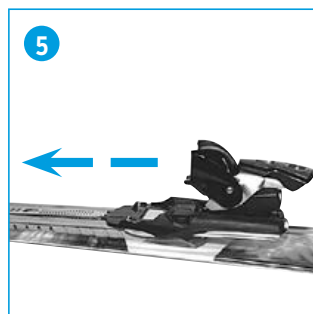
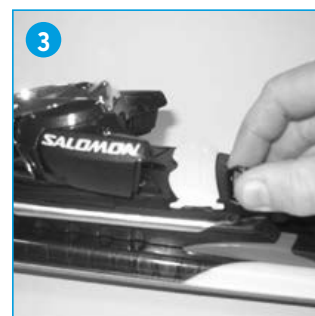
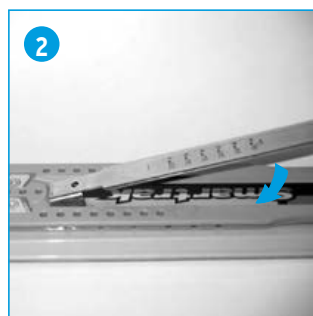
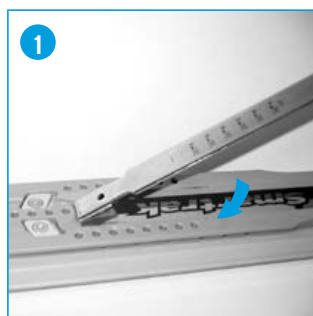

ADJUSTING EXAMPLE

6. Identify the length of the boot.
7. If you have boot sole L 306 mm, adjust the Toe on the 308 mm mark. The range in this case is 301 mm to 308 mm (fig. 7).
8. If you have chosen the L 306 mm, adjust the Heel piece on the 312 location. The range in this case is 305 mm to 312 mm (fig. 8).
9. Step in the boot and check forward pressure (fig. 9). The arrow on the housing must be within the scribed area.

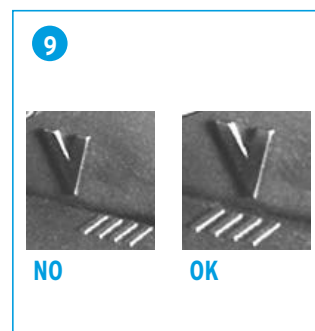
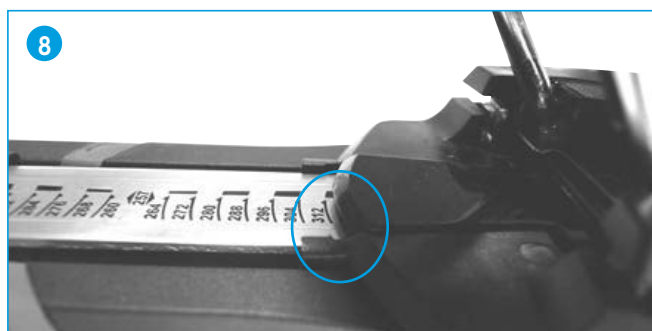
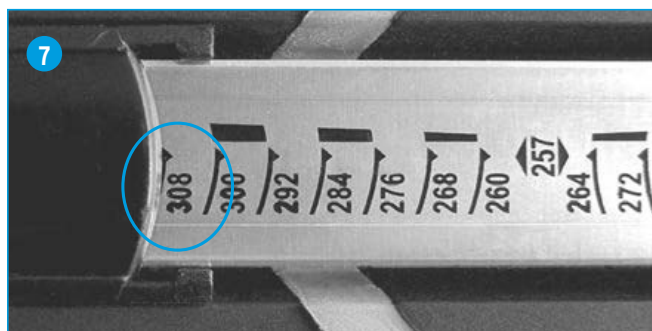

MXT BINDINGS

TO BE MOUNTED BY A SALOMON AUTHORIZED DEALER ONLY.

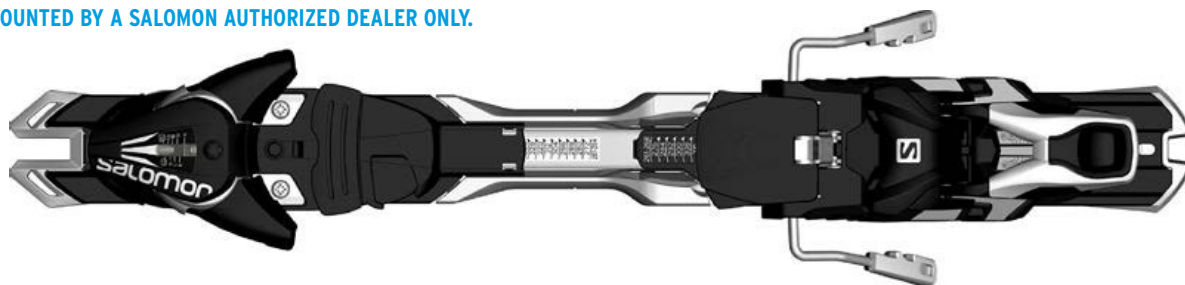

MOUNTING AND AJUSTING

1. Remove the grey plastic part from the ski blade before toe assembly (fig. 1).
2. Insert the toe piece from the front and position on the track according to the boot sole length (fig. 2).
3. Insert the heel and break piece from the back and position on the track according to the boot sole length (fig. 3).
4. Boot sole length adjustment (fig. 4).
5. Step in the boot and check forward pressure (fig. 5).
6. Select and adjust the setting release values for toe and heel pieces (fig. 6).

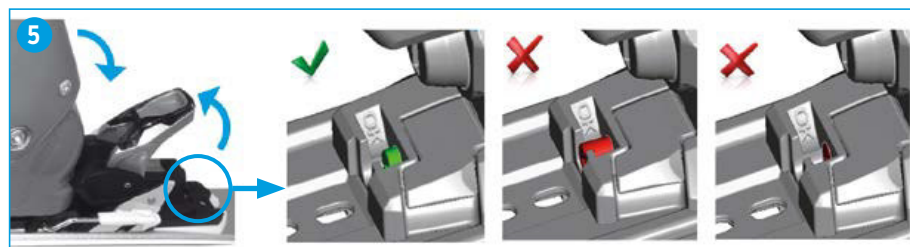
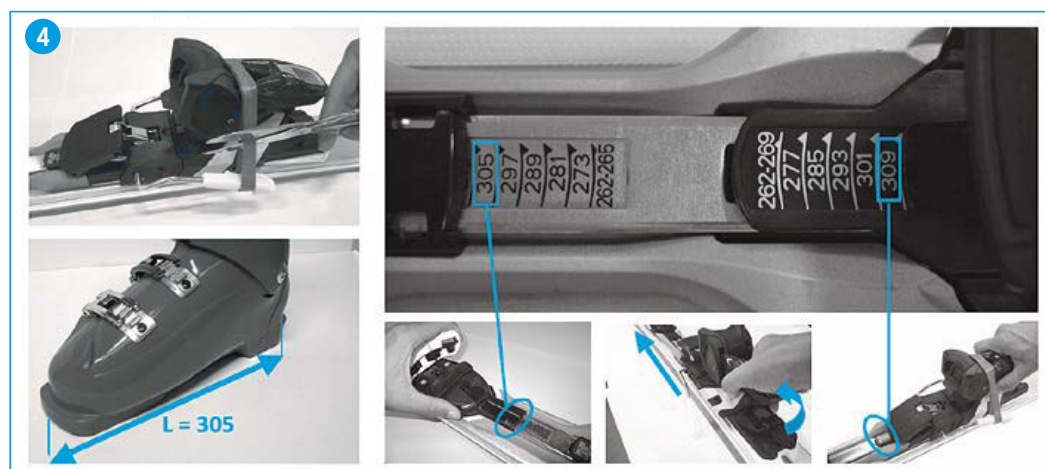
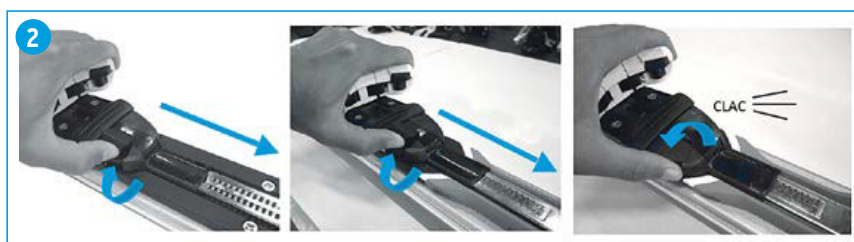

SMARTRAK GRIP / GRIP PLUS

TO BE MOUNTED BY A SALOMON AUTHORIZED DEALER ONLY.

CONTENTS OF THE BOX

- › 2 Toes
- › 2 Heels mounted on a sliding part
- › 2 Brakes
- › 2 Thin Plates
- › 1 Notice



MOUNTING AND AJUSTING

1. Insert the Thin Plate in the seating ahead the plate (fig. 1).
2. Place it correctly with a rotational motion (fig. 2).
3. Identify the length of the boot.
4. Identify the letter that corresponds your sole length. (If you are between two, choose the higher one) (fig. 3).
5. Screw the center mounting track to this letter. (4Nm Torque) (fig. 4).
Mount the Toe piece as usual (fig. 5).
6. From the rear, slide the Heel piece on the interface using the manual lock to authorize the sliding (fig. 6).
7. Mount the Brake following the usual procedure (fig. 7).
8. Position your boot in the toe and slide the heel until it touches the boot (fig. 8).
9. Step in the boot and check forward pressure (fig. 9).
The arrow on the housing must be within the scribed area

Info: The rear N° is an indication for a quick adjustment of the second ski (fig. 10).

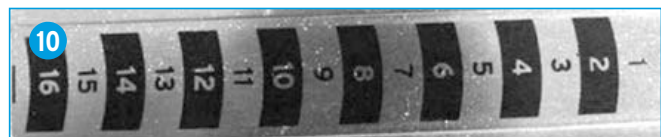
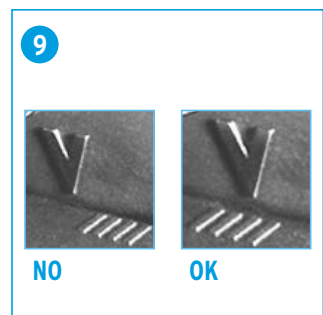
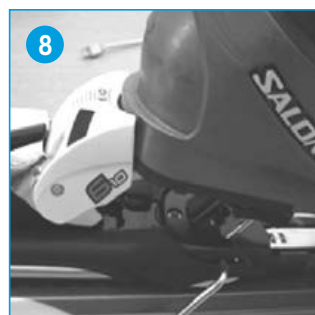
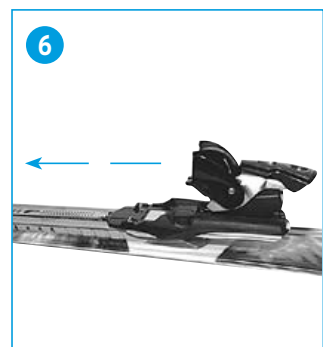
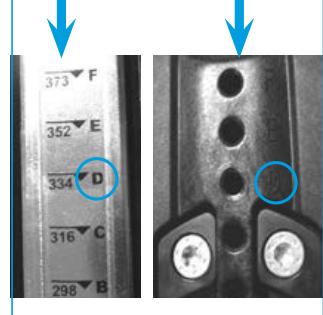
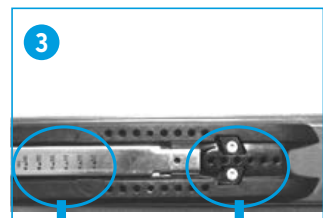

LIGHTRAK PLATE J L & H L

TO BE MOUNTED BY A SALOMON AUTHORIZED DEALER ONLY.



MOUNTING AND AJUSTING

1. Open and set the blade in straight position and place it on the plate with a rotational motion (fig. 1).
2. Identify the length of the boot sole.
3. Mounting of the toe piece:
 - J L model: Identify the letter that corresponds the sole length and screw the toe piece (if you are between two letters, choose the higher one).
 - H L model: From the rear, slide the toe piece on the interface until it corresponds with or is just above the sole length, push the bolt until the "clac" to lock on the toe piece (fig. 2).

Note: to move the toe, insert a screwdriver and with a rotational motion lock off the bolt (fig. 3).

4. Mounting of the heel piece:

J L model:

- From the rear, slide the heel piece on the interface using the manual lock to authorize the gliding (fig. 4).
- Mount the brake following the usual procedure (fig. 5).
- Position the boot in the toe and slide the heel until it touches the boot.
- Step in the boot and check forward pressure, the arrow on the lock must be within the scribed area (fig. 6).

Note: the rear N° on the blade is an indication for a quick adjustment of the second ski.

H L model:

- From the rear, slide the heel piece on the interface using the manual lock to authorize the gliding (fig. 4).
- Mount the brake following the usual procedure (fig. 5).
- Slide the heel piece until it corresponds with or it just above the sole length.
- Step in the boot and check forward pressure, the arrow on the lock must be within the scribed area (fig. 6).

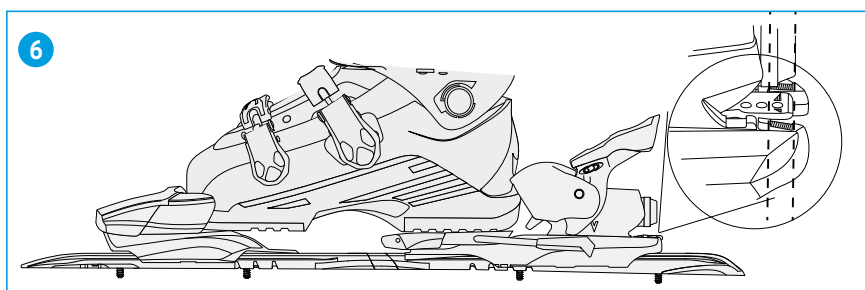
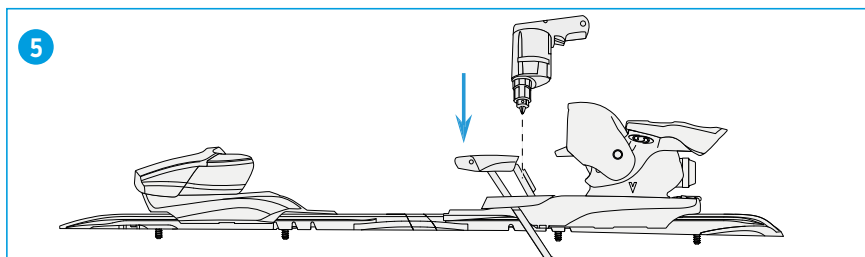
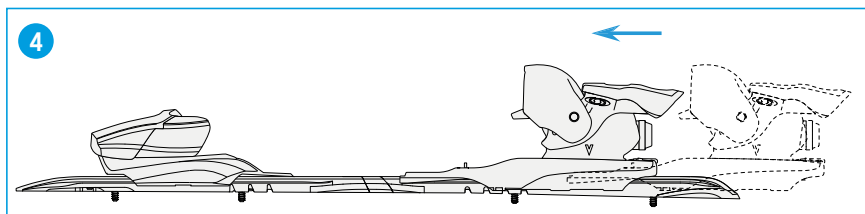
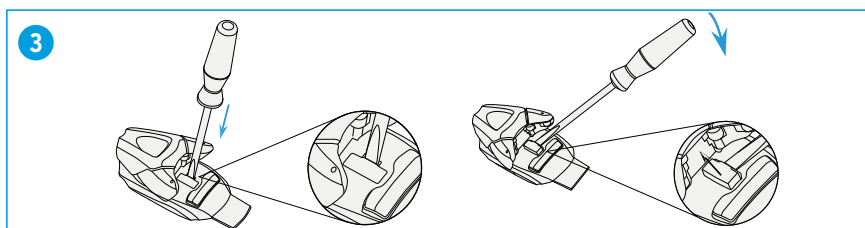
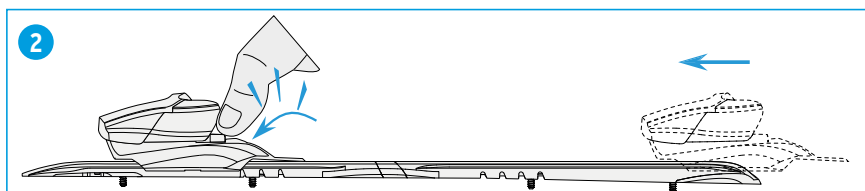
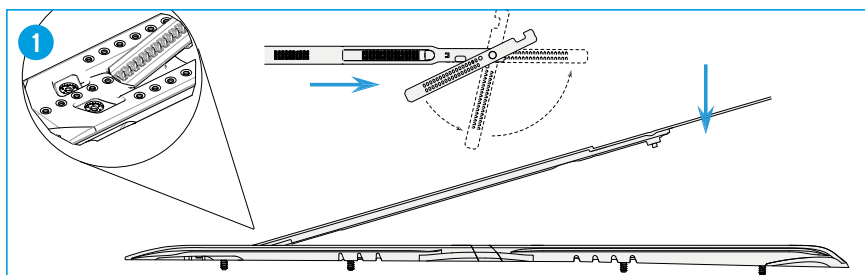

BINDING MODEL - SPECIFIC INSTRUCTIONS

X 12 & X 16

TO BE MOUNTED BY A SALOMON AUTHORIZED DEALER ONLY.

DRILLING SKIS

- For mounting the X 12 & X 16 bindings on skis, holes have to be drilled with the Salomon mounting jig (ref. 11847301) to ensure a proper alignment of the binding.
- Check the boot sole length you would like to mount the binding for and drill the "S" ; "M" holes which are marked on the jig following the instructions in the chart below :
- Drill your chosen setup and remove the mounting jig.

Note: The X 12 & X 16 bindings have an additional hole in the middle to fix the brake, don't forget to drill this hole.

Sole lengths in mm	Monting oh Heel rail	Mounting of toe rail	Toe PIECE POSITION on the toe rail	Bootcenter related to the "real" bootcenter position in mm	Maximum of positions to adjust the boot center +/-	
					Forward	Backward
265	"S"	"M"	Position 7	"+"... forward "- "... backward + 7,0 mm	+2	0
275	"S"	"M"	Position 7	+ 2,0 mm	+2	-1
285	"S"	"M"	Position 7	- 3,0 mm	+3	-1
295	"S"	"M"	Position 6	- 0,5 mm	+4	-1
305	"S"	"M"	Position 5	+ 2,0 mm	+1	-2
315	"M"	"M"	Position 5	- 3,0 mm	+3	-1
325	"M"	"M"	Position 4	- 0,5 mm	+2	-1
335	"M"	"M"	Position 3	+ 2,0 mm	+3	-1
345	"M"	"M"	Position 3	- 3,0 mm	+2	-1
355	"M"	"M"	Position 2	- 0,5 mm	+2	-1
max 360	"M"	"M"	Position 2	- 3,0 mm	+2	0

MOUNTING PROCEDURE

- Mount the base plate toe by tightening the screws at min. 4 Nm.
- Mount the heel base plate by tightening the screws at min. 4 Nm and mount the brake by tightening the screws in the middle at min. 4 Nm.
- Push the "VAR" lever over to the right and slide the toe piece from the middle towards the tip of the ski.
- Move the toe piece to the number corresponding to the boot sole length you would like to mount the binding for.
- Slide the heelpiece from the tail forward.
- Match up the steel band with the boot sole length you would like to mount the binding for.
- Take the "AFD" pedal and place it in the middle and fix it with screw at max. 4 Nm.
- Put the boot into the binding and check the forward pressure. The screw head needs to be aligned with the housing.

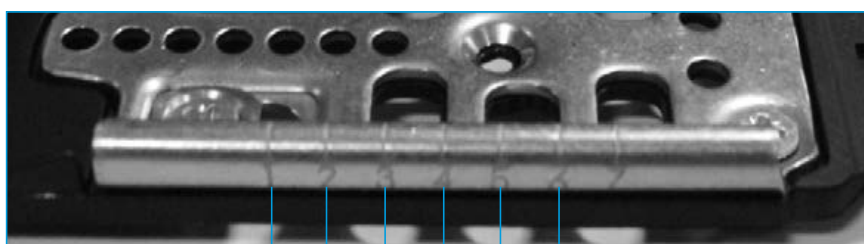
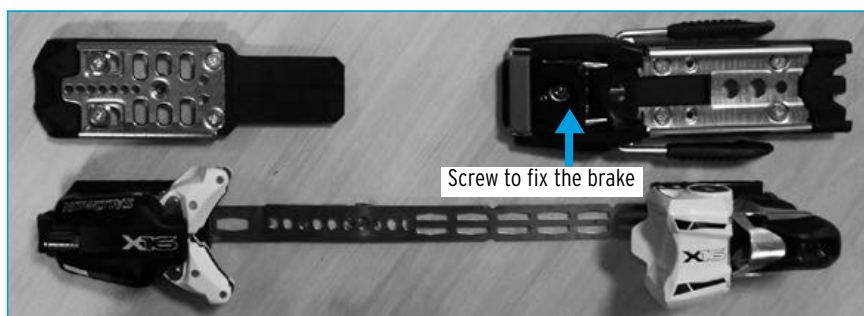

1 2 3 4 5 6
Toe piece

Z SPEED PLATE

TO BE MOUNTED BY A SALOMON AUTHORIZED DEALER ONLY.

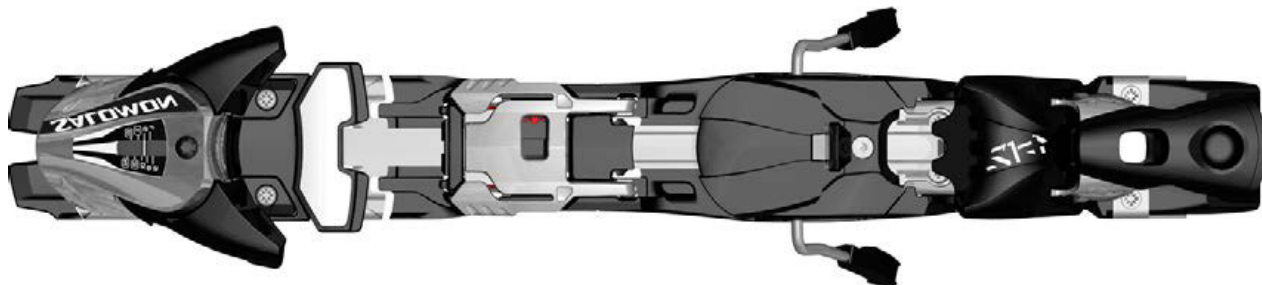

MOUNTING AND ADJUSTING

1 - For mounting Z Speed bindings on skis, holes have to be drilled with the Salomon mounting jig (ref 11139301) to ensure a proper alignment of the binding.

2 - Mount the rear plate by tightening the screws at 4 N.m.

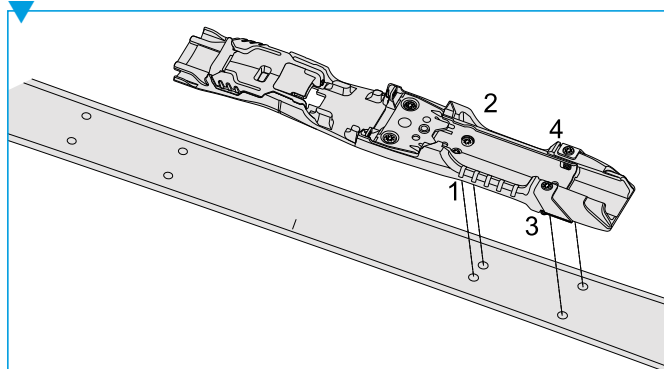

3 - Mount the front plate by tightening the screws at 4 N.m.

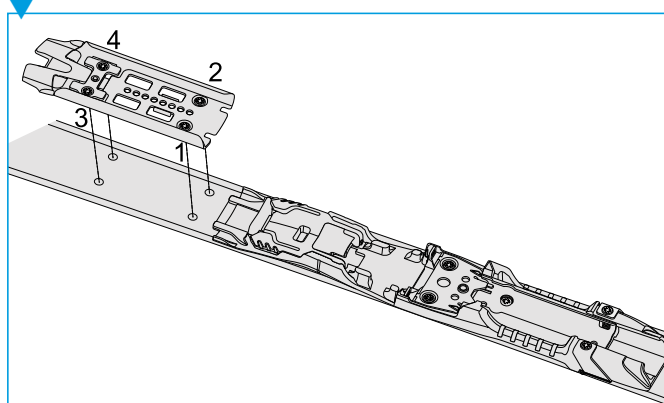

4 - Press and open the central lever.

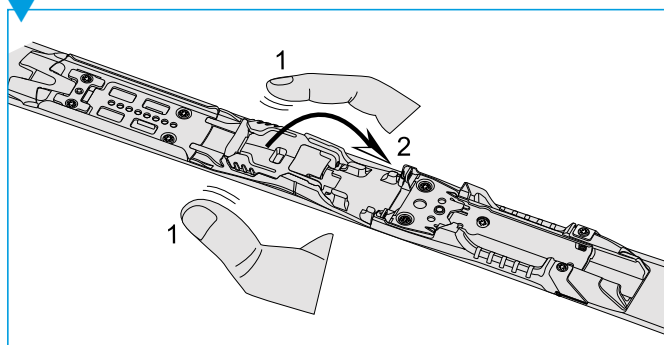

5 - Mount the brake by tightening the screw at 4 N.m with tool Torx 25.

6 - Slide the toe piece from the front backward and the heel piece from the tail forward.

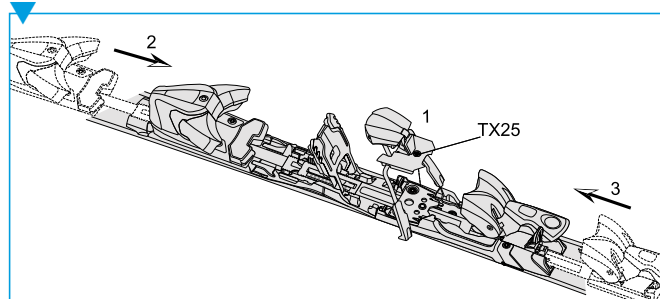

7 - Select the length of the sole boot and adjust the toe and heel pieces at the length corresponding.

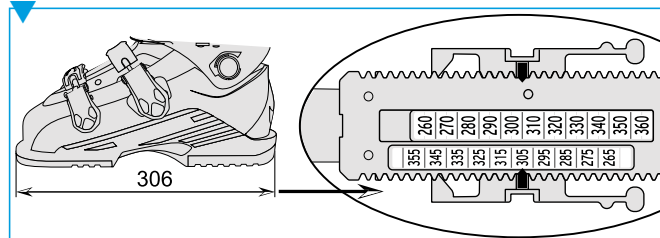

8 - Close and lock on the central lever.

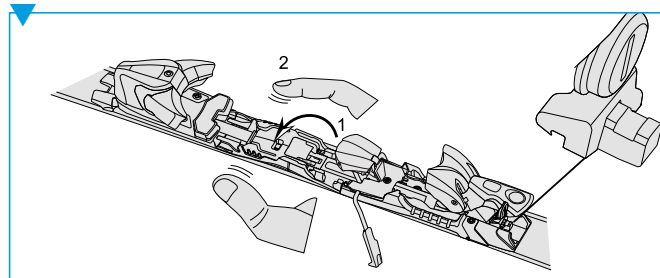

9 - Step in the boot and check the forward pressure.

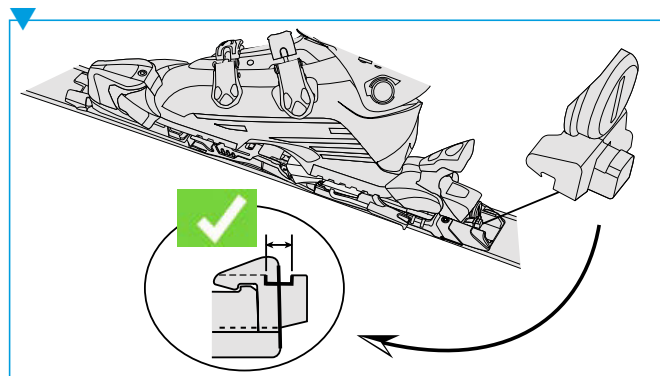

EASYTRAK WITH L & C BINDING

TO BE MOUNTED BY A SALOMON AUTHORIZED DEALER ONLY.

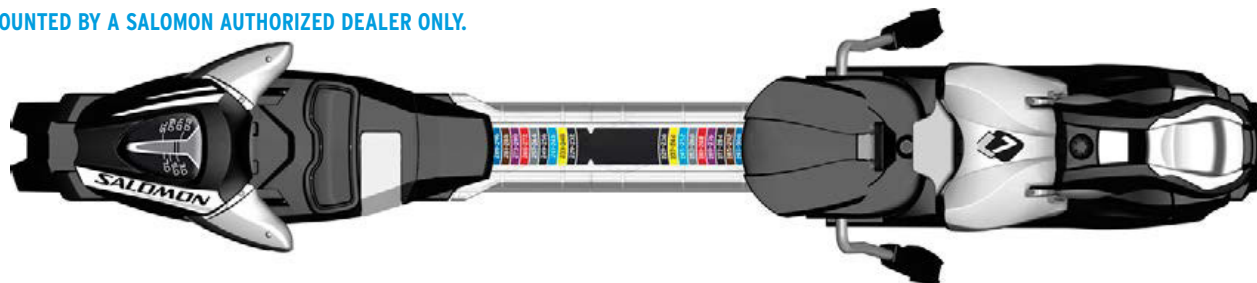

MOUNTING AND ADJUSTING

EASYTRAK L7, L9 & L 10

1 - Insert the toe piece from the front and position on the track according to the boot sole length.

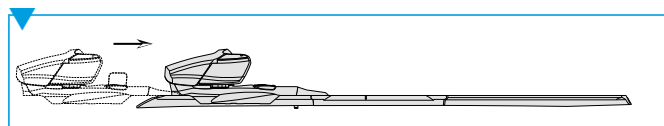

2 - Insert the heel piece from the back and position on the track according to the boot sole length.

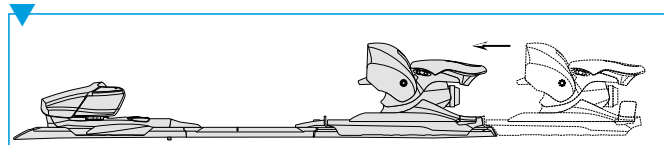

3 - Assemble the break.

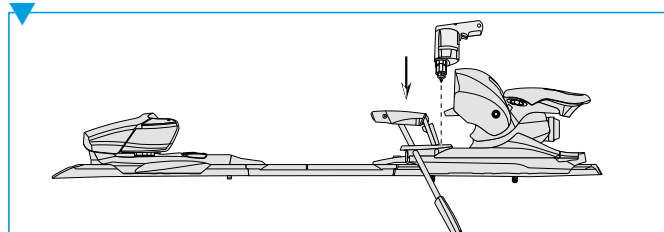

4 - Step in the boot and check forward pressure.

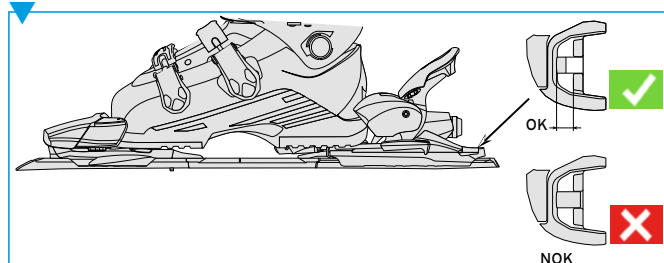

EASYTRAK C5

1 - Insert the toe piece from the front and position on the track according to the boot sole length.

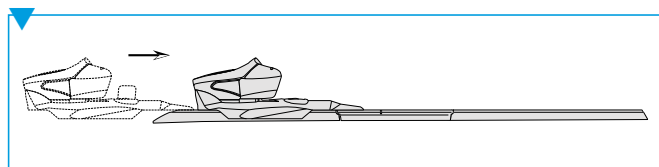

2 - Insert the heel piece from the back and position on the track according to the boot sole length.

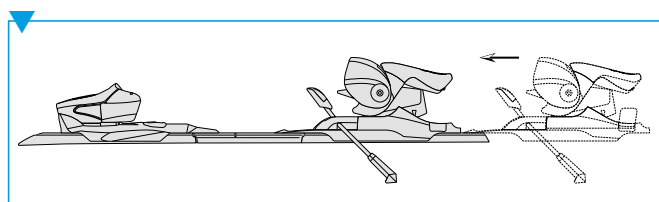

3 - Step in the boot and check forward pressure.

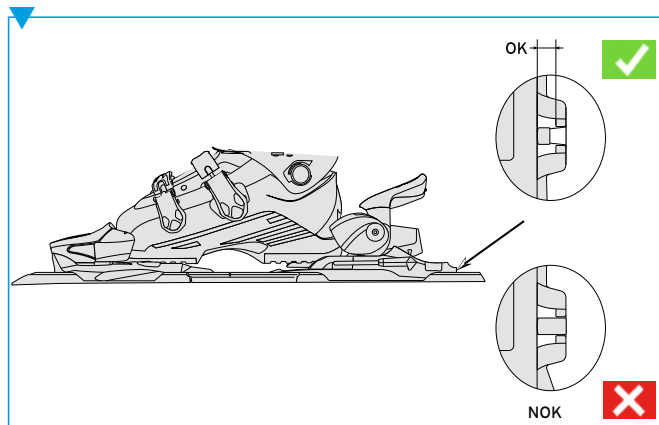

example showing adjustment for boot size 295

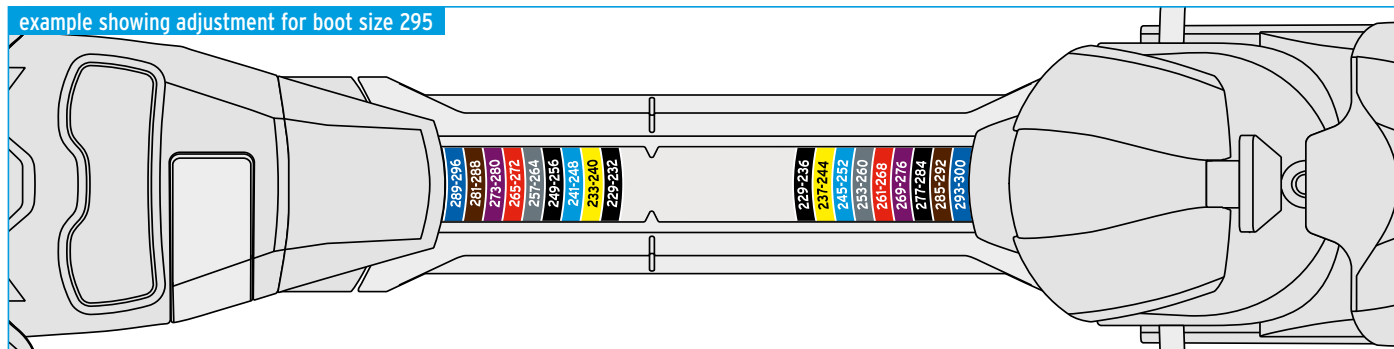

EASYTRAK WITH LITHIUM BINDING

TO BE MOUNTED BY A SALOMON AUTHORIZED DEALER ONLY.

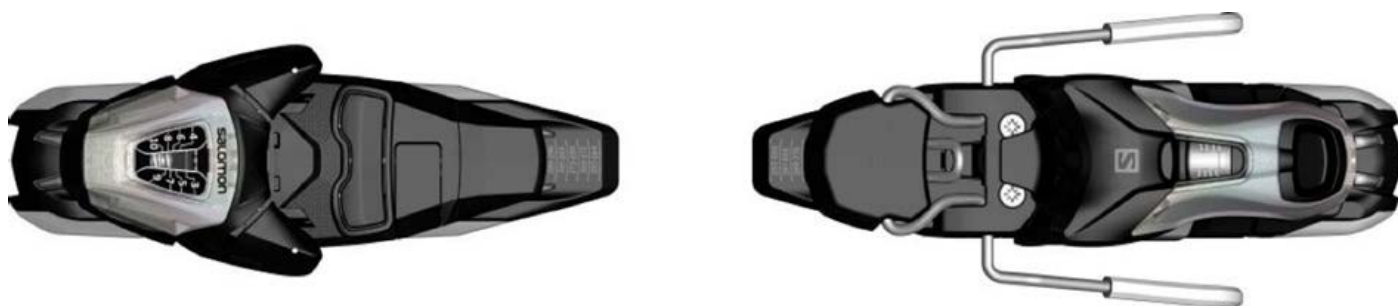

MOUNTING & ADJUSTING

1. Use the Salomon mounting jig (ref:30863001) and drill the skis following the ski and binding manufacturer's instructions. Mount the front and rear plate on the ski by tightening the screws at 4 N.m. ▼

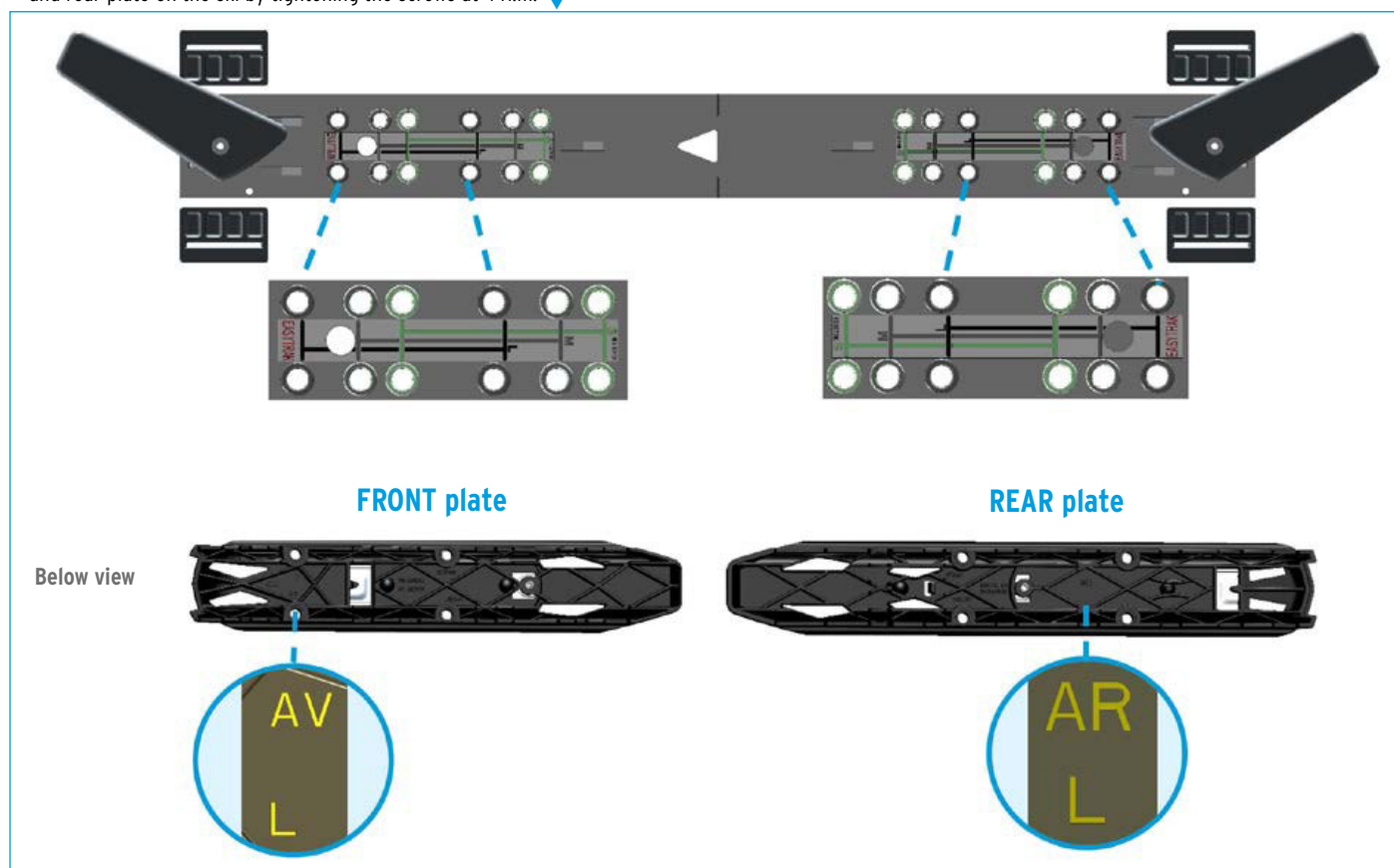

2. Insert the toe piece from the front and position on the track according to the boot sole length ▼

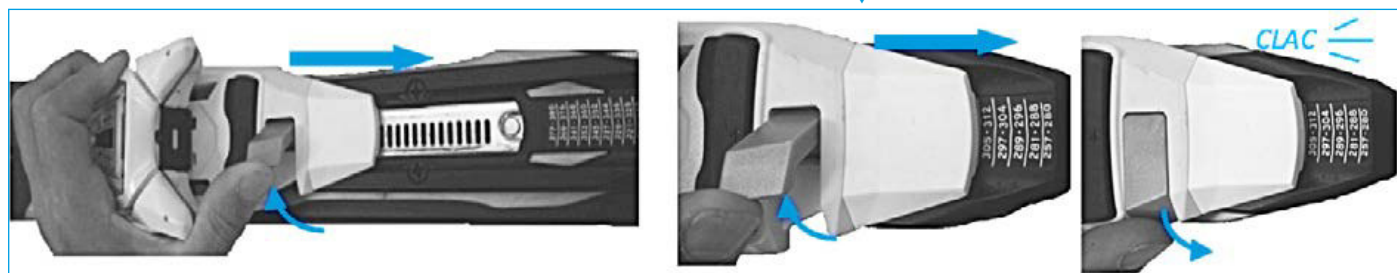

>>>

3. Insert the heel and break piece from the back and position on the track according to the boot sole length ▼

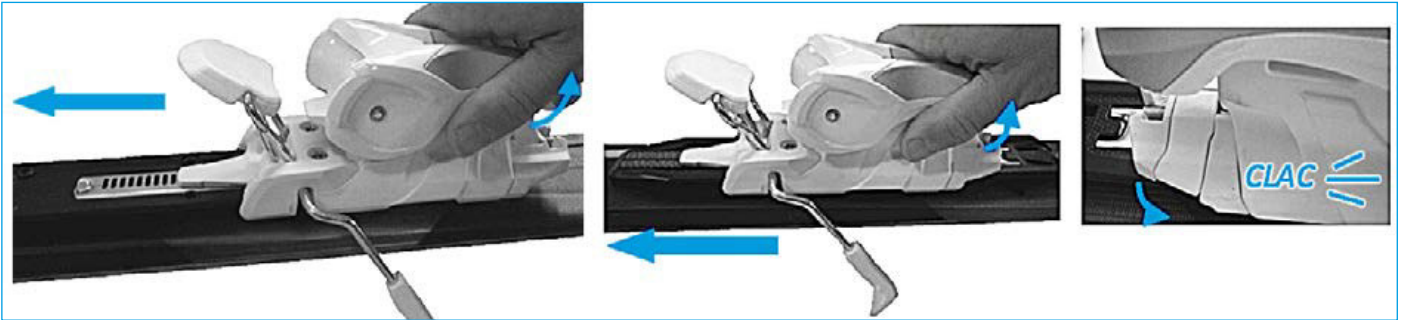

4. Boot sole length adjustment ▼

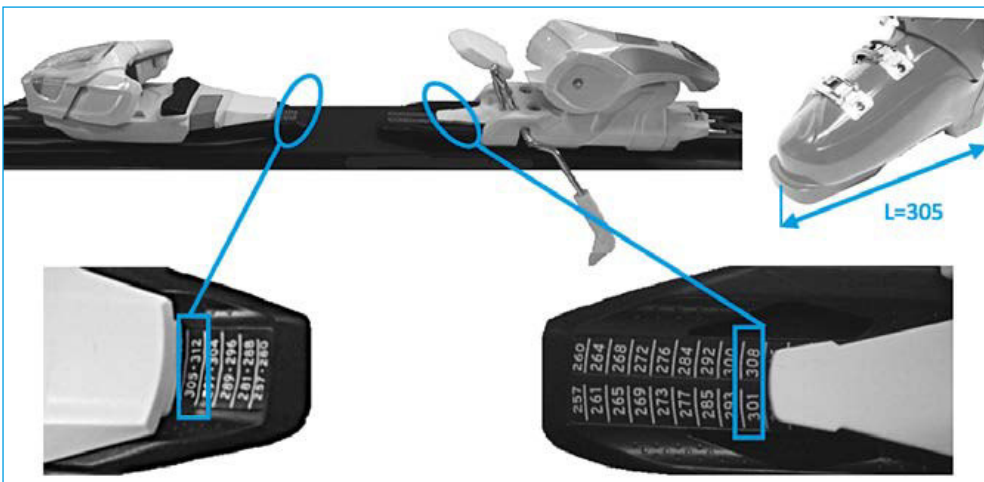

5. Step in the boot and check forward pressure ▼

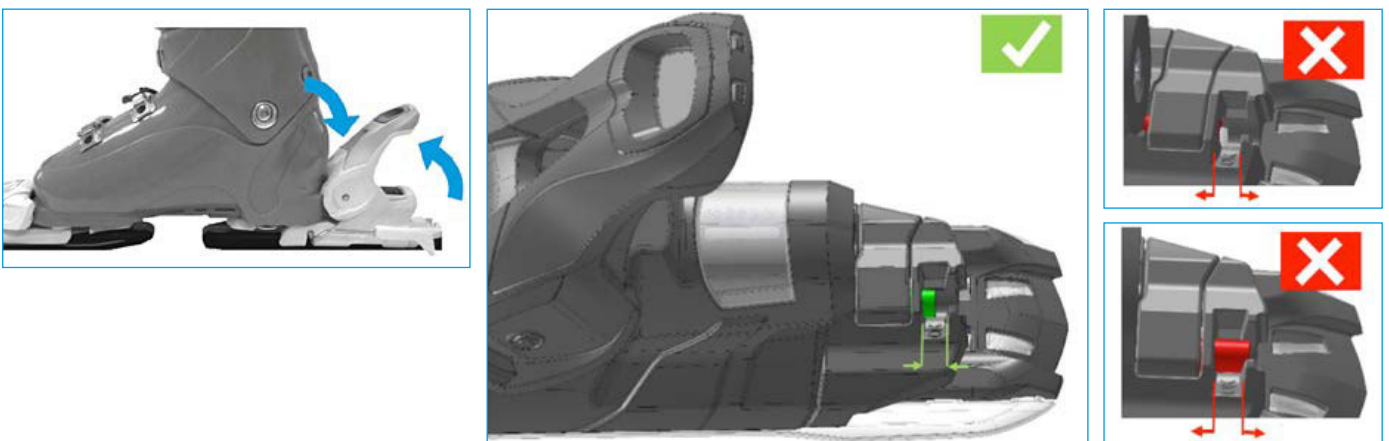

6. Select and adjust the setting release values for toe and heel pieces ▼



BINDING MODEL - SPECIFIC INSTRUCTIONS

WARDEN 11

TO BE MOUNTED BY A SALOMON AUTHORIZED DEALER ONLY.



WARNING

THESE ALPINE BINDINGS ARE INTENDED TO BE USED ONLY WITH THE FOLLOWING SKI BOOTS:

> Alpine ski boots compliant with ISO 5355 standard.

Any use with other ski boots could cause the ski-binding-boot system to be faulty and affect release characteristics, which would increase the risk of serious injury while skiing.

Therefore, skiers are warned not to use this product with any ski boots other than those meeting the standards indicated above. Skiers are advised to consult the dealer where this product was purchased, or an equipment specialist at any SALOMON authorized ski dealer of this product, for further information regarding which ski boots meet the standards listed above.

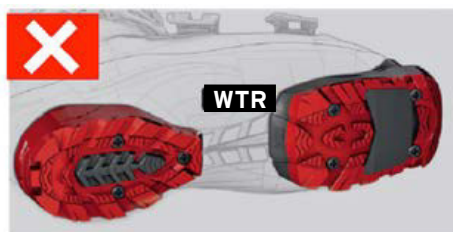

MOUNTING & ADJUSTING

1 - For mounting Warden 11 binding on skis, holes have to be drilled with the Salomon mounting jig (ref 39109101) to ensure a proper alignment of the binding. Mount the toe piece and the rear plate on ski by tightening the screws at 4 N.m (fig. 1).

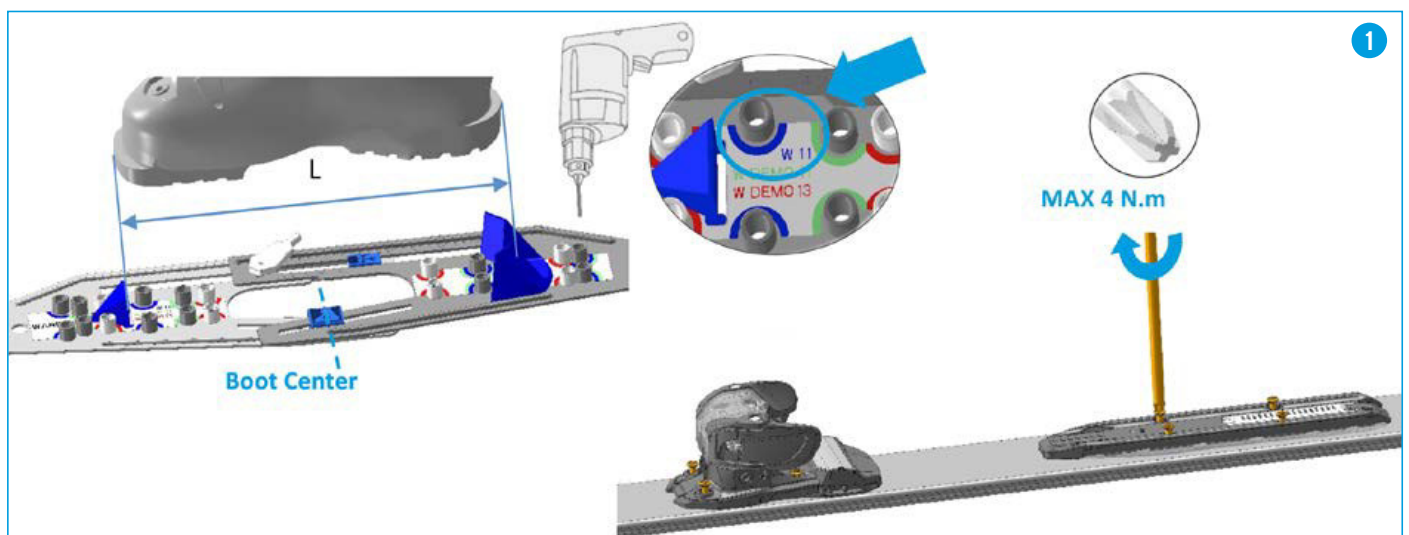

>>>

2. Insert the heel and brake piece from the back and align the brake indicator with marking on the plate (fig. 2).
3. Step in the boot (fig. 3).
4. Adjust the toe height with adjustment screw until to create a gap of 0,5mm between the boot sole and the binding (fig. 4).
5. Check and adjust the forward pressure (fig. 5).
6. Select and adjust the setting release values for toe and heel pieces (fig. 6).

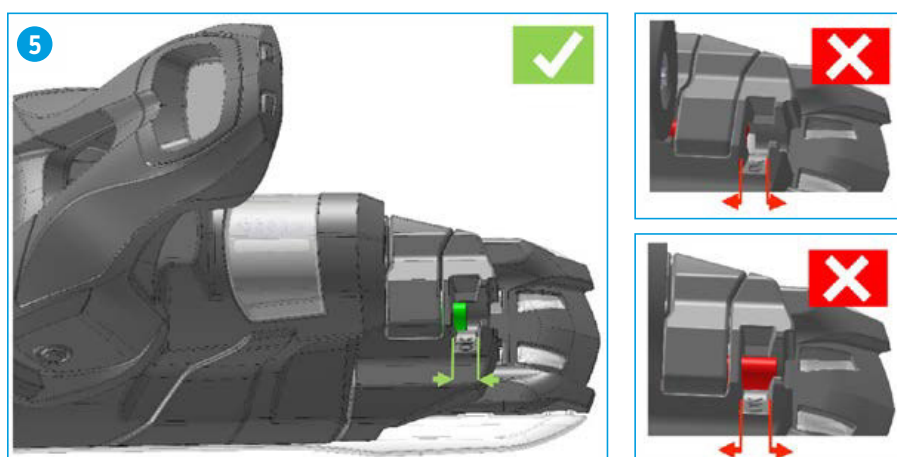
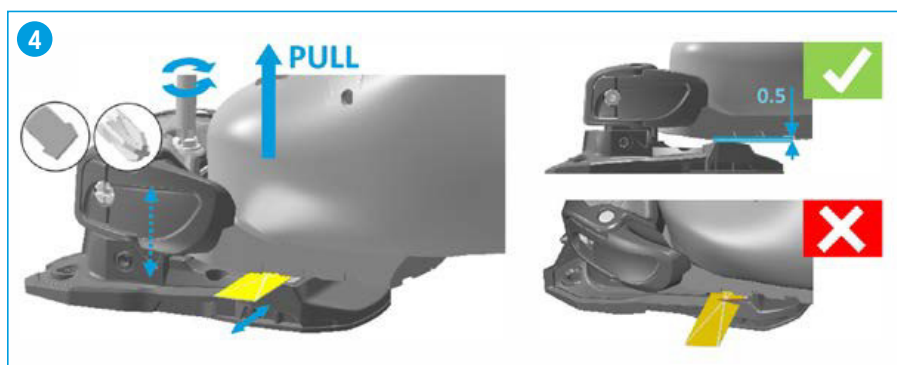

BINDING MODEL - SPECIFIC INSTRUCTIONS

WARDEN 11 DEMO

TO BE MOUNTED BY A SALOMON AUTHORIZED DEALER ONLY.



WARNING

THESE ALPINE BINDINGS ARE INTENDED TO BE USED ONLY WITH THE FOLLOWING SKI BOOTS:

> Alpine ski boots compliant with ISO 5355 standard.

Any use with other ski boots could cause the ski-binding-boot system to be faulty and affect release characteristics, which would increase the risk of serious injury while skiing.

Therefore, skiers are warned not to use this product with any ski boots other than those meeting the standards indicated above. Skiers are advised to consult the dealer where this product was purchased, or an equipment specialist at any SALOMON authorized ski dealer of this product, for further information regarding which ski boots meet the standards listed above.

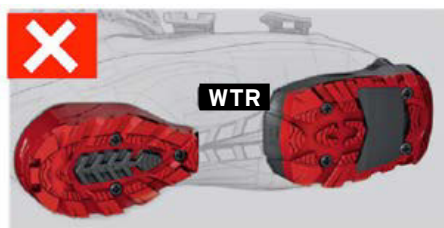

MOUNTING & ADJUSTING

1. For mounting Warden 11 DEMO binding on skis, holes have to be drilled with the Salomon mounting jig (ref 39109101) to ensure a proper alignment of the binding. Mount the toe piece and the rear plate on ski by tightening the screws at 4 N.m (fig. 1).

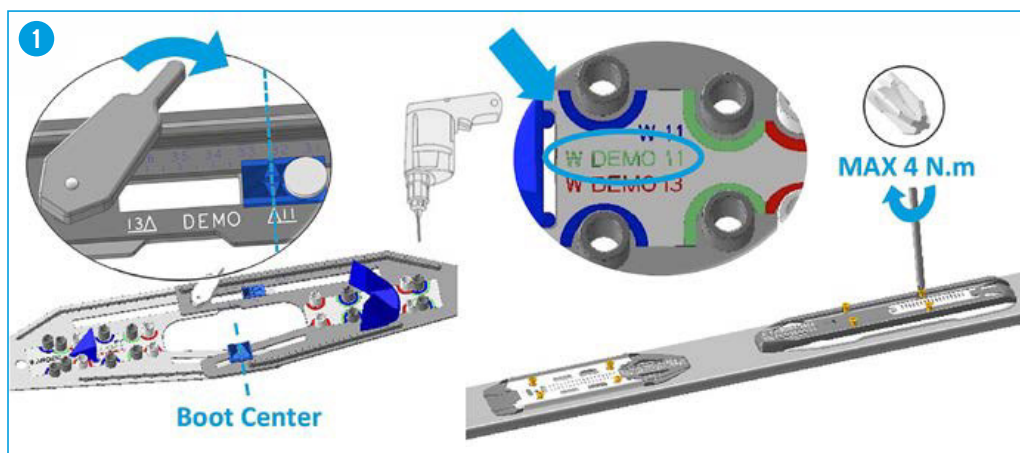

2. Insert the heel and brake piece from the back and position on the plate according to the boot sole length (fig. 2).

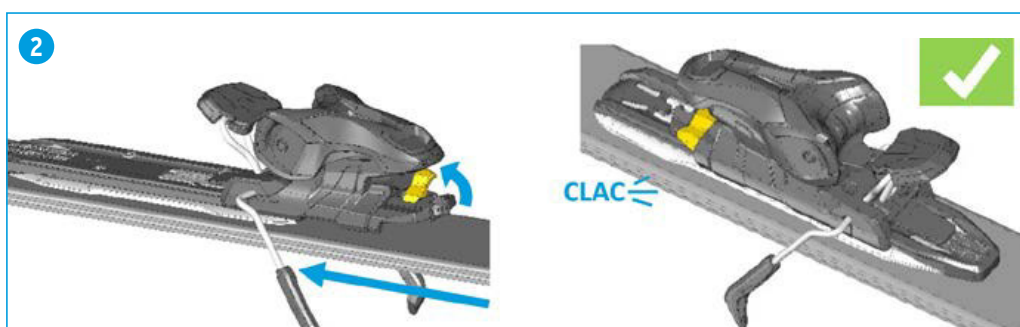

>>>

3. Insert the toe piece from the front and position on the plate according to the boot sole length (fig. 3).



4. Boot sole length adjustment (fig. 4).

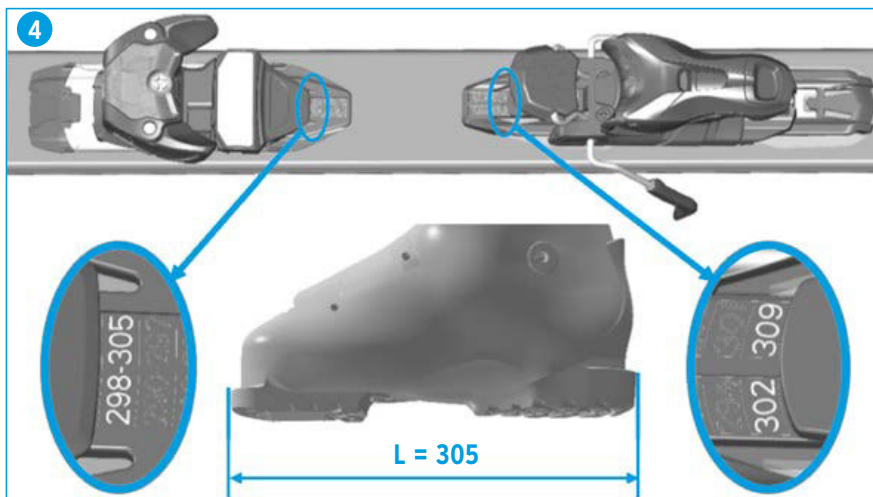

5. Step in the boot (fig. 5).



6. Adjust the toe height with adjustment screw until to create a gap of 0,5mm between the boot sole and the binding (fig. 6).



7. Check and adjust the forward pressure. (fig. 7).

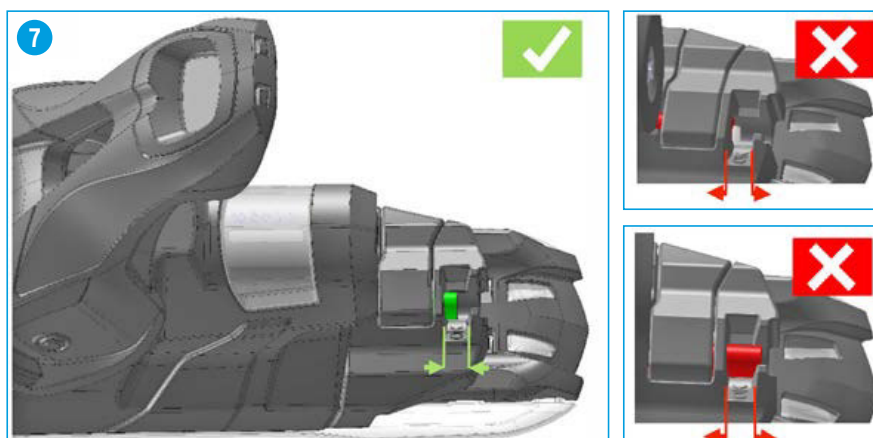

8. Select and adjust the setting release values for toe and heel pieces (fig. 8).



BINDING MODEL - SPECIFIC INSTRUCTIONS

WARDEN 13 MNC (MULTI-NORM CERTIFIED) DEMO

TO BE MOUNTED BY A SALOMON AUTHORIZED DEALER ONLY.

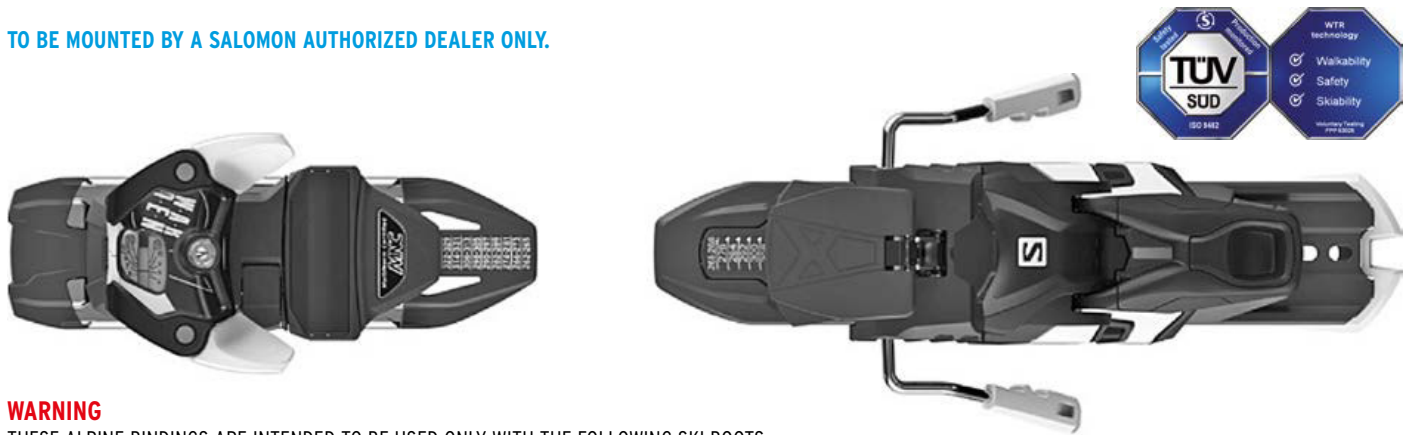

WARNING

THESE ALPINE BINDINGS ARE INTENDED TO BE USED ONLY WITH THE FOLLOWING SKI BOOTS:

- Alpine ski boots compliant with ISO 5355 standard AND
- Ski boots equipped with « WTR technology » labelled kit of walking
- Touring boots compliant with ISO 9523 standard.

Any use with other ski boots could cause the ski-binding-boot system to be faulty and affect release characteristics, which would increase the risk of serious injury while skiing.

Therefore, skiers are warned not to use this product with any ski boots other than those meeting the standards indicated above. Skiers are advised to consult the dealer where this product was purchased, or an equipment specialist at any SALOMON authorized ski dealer of this product, for further information regarding which ski boots meet the standards listed above.

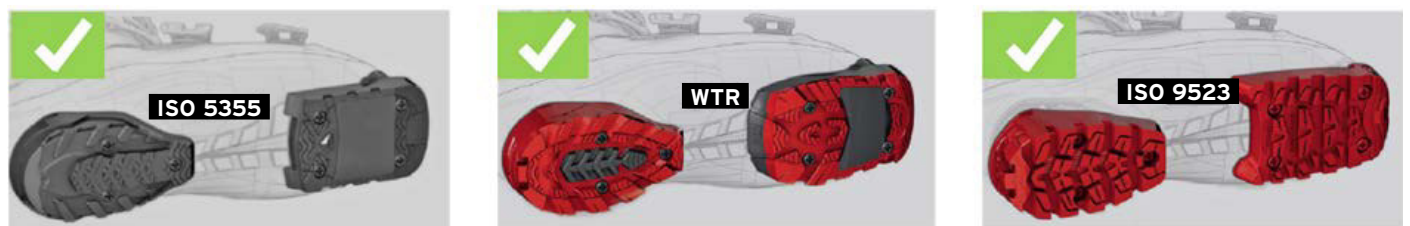

MOUNTING & ADJUSTING

1. For mounting Warden 13 MNC DEMO binding on skis, holes have to be drilled with the Salomon mounting jig (ref 39109101) to ensure a proper alignment of the binding. Mount the toe piece and the rear plate on ski by tightening the screws at 4 N.m. ▼

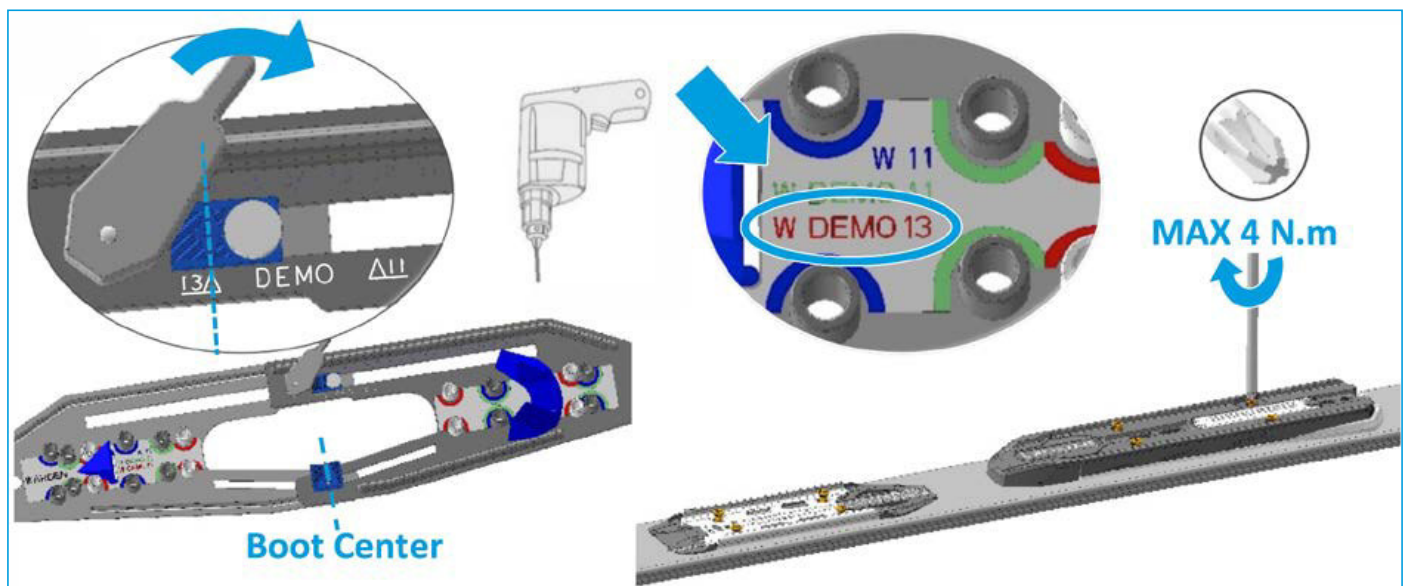

>>>

2. Assemble the ski brake with the heel piece. ▼



3. Insert the heel and brake piece from the back and position on the plate according to the boot sole length. ▼



4. Insert the toe piece from the front and position on the plate according to the boot sole length. ▼

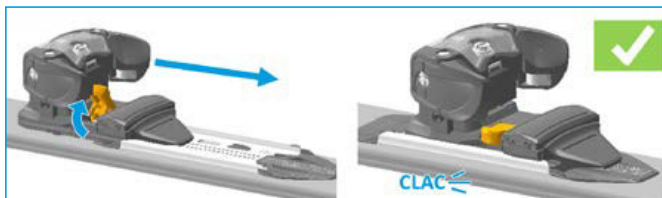

5. Boot sole length adjustment. ▼

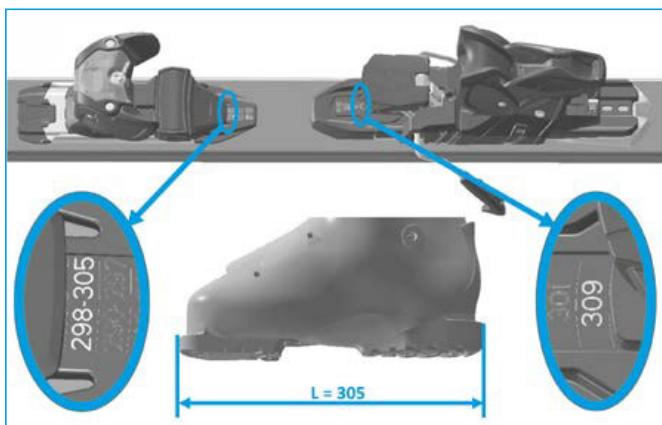

6. Step in the boot. ▼

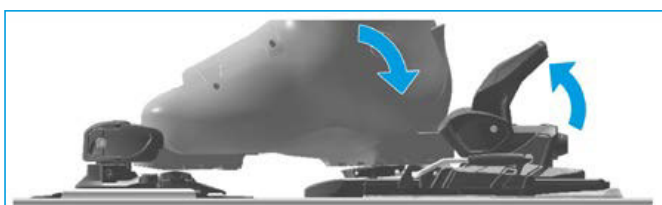

7. Adjust the toe height with adjustment screw until to create a gap of 0,5mm between the boot sole and the binding. ▼

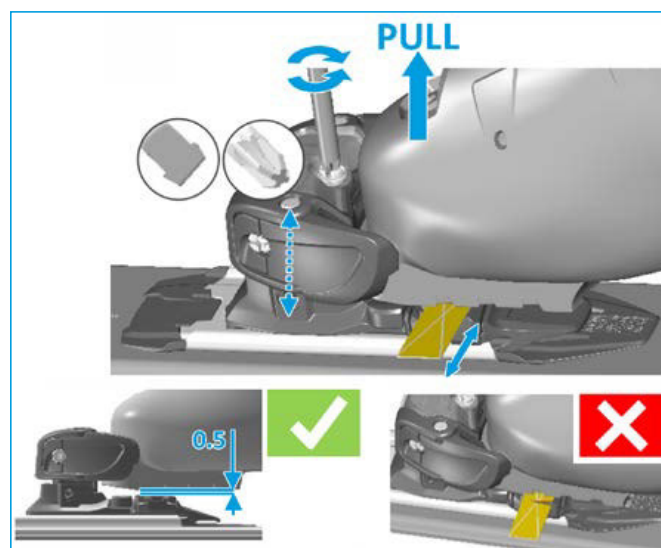

8. Check and adjust the forward pressure. ▼

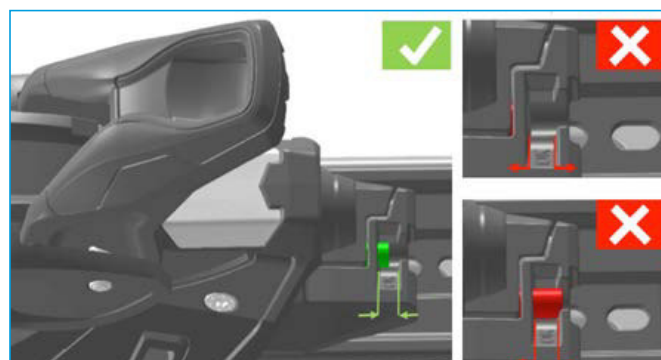

9. Select and adjust the setting release values for toe and heel pieces. ▼



10. In case of adjustment with touring boots compliant with ISO 9523 standard, paste sticker on each skis. ▼

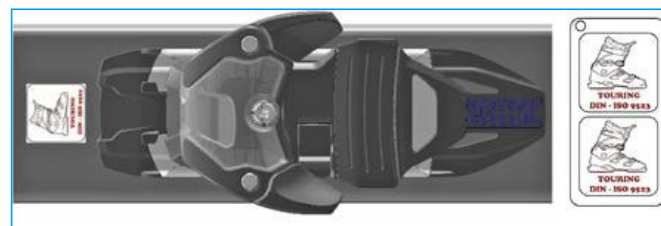

BINDING MODEL - SPECIFIC INSTRUCTIONS

WARDEN 13 MNC (MULTI-NORM CERTIFIED) BINDING

TO BE MOUNTED BY A SALOMON AUTHORIZED DEALER ONLY.



WARNING

THESE ALPINE BINDINGS ARE INTENDED TO BE USED ONLY WITH THE FOLLOWING SKI BOOTS:

- Alpine ski boots compliant with ISO 5355 standard AND
- Ski boots equipped with « WTR technology » labelled kit of walking
- Touring boots compliant with ISO 9523 standard.

Any use with other ski boots could cause the ski-binding-boot system to be faulty and affect release characteristics, which would increase the risk of serious injury while skiing.

Therefore, skiers are warned not to use this product with any ski boots other than those meeting the standards indicated above. Skiers are advised to consult the dealer where this product was purchased, or an equipment specialist at any SALOMON authorized ski dealer of this product, for further information regarding which ski boots meet the standards listed above.

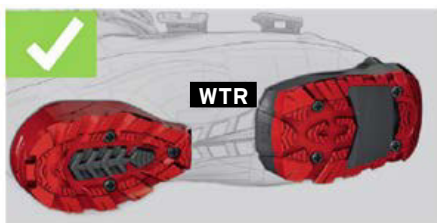

MOUNTING & ADJUSTING PROCEDURE

1. Use the Salomon mounting jig (ref 3298160001) to ensure a proper alignment of the binding.

Drill the skis following the ski and binding manufacturer's instructions. Mount the toe piece and the rear plate on the ski by tightening the screws at 4 N.m (check if rear plate is correctly mounted).



>>>

2. Assemble the ski brake with the heel piece



3. From the center of ski, insert the heel piece on the rear plate and adjust at the "mid" position with screwdriver.



4 Step in the ski boot in the binding. Check and adjust the forward pressure.

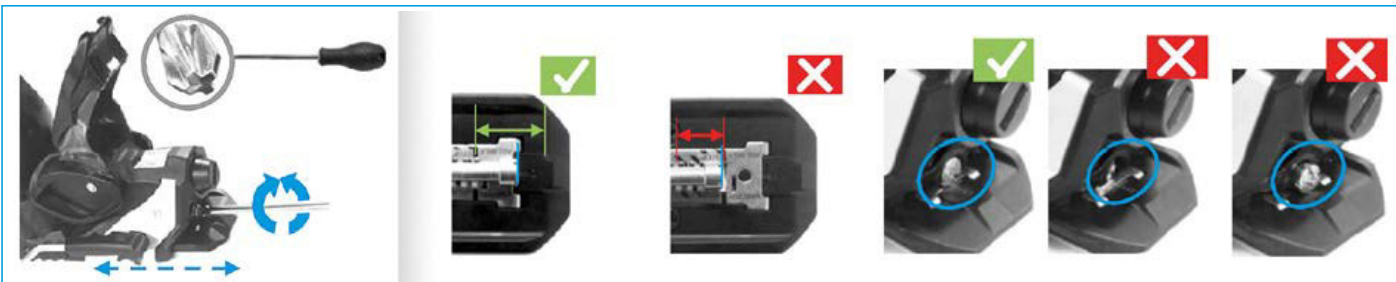

5. Select and adjust the setting release values for toe and heel pieces.



6. Adjust the toe height with adjustment screw until to create a gap of 0.5mm between the boot sole and the binding.

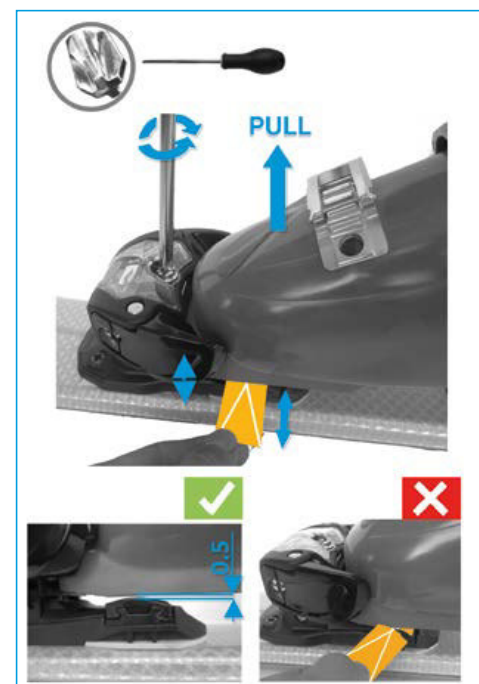

7. In case of adjustment with touring boots compliant with ISO 9523 standard, paste sticker on each ski.



GUARDIAN MNC -MULTI-NORM CERTIFIED- BINDING (BACKCOUNTRY)

TO BE MOUNTED BY A SALOMON AUTHORIZED DEALER ONLY.

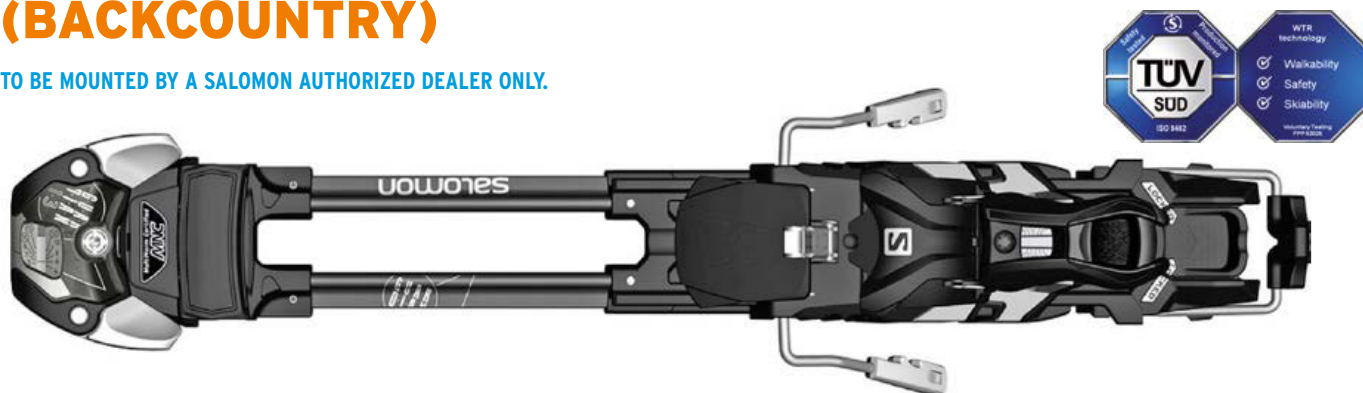

WARNING

THESE ALPINE BINDINGS ARE INTENDED TO BE USED ONLY WITH THE FOLLOWING SKI BOOTS:

- Alpine ski boots compliant with ISO 5355 standard AND
- Ski boots equipped with « WTR technology » labelled kit of walking
- Touring boots compliant with ISO 9523 standard.

Any use with other ski boots could cause the ski-binding-boot system to be faulty and affect release characteristics, which would increase the risk of serious injury while skiing.

Therefore, skiers are warned not to use this product with any ski boots other than those meeting the standards indicated above. Skiers are advised to consult the dealer where this product was purchased, or an equipment specialist at any SALOMON authorized ski dealer of this product, for further information regarding which ski boots meet the standards listed above.

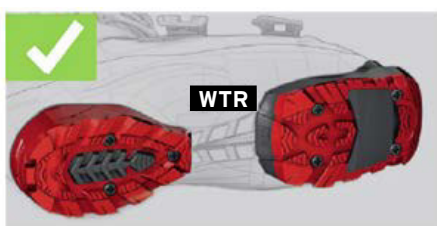

MOUNTING & ADJUSTING PROCEDURE

1. For mounting Backcountry bindings, holes have to be drilled with the Salomon mounting jig (ref 3267050001) to ensure a proper alignment of the binding.

2. Mount the toe base plate and the step-in by tightening the screws at 4 N.m



3. Remove shaft and screw from plastic bag



4. Insert the toe piece in the base plate



5. Insert the shaft and the screw and tighten with a screwdriver (Torx T25 (x2)) - Maxi 4 N.m



>>>

>>>

6. Placing ski brake

> Refer to the Salomon spare part catalogue to know which brake to use according to the different ski widths and binding models.

■ (fig. 1) Take the ski brake (A), insert the two lugs and assemble the ski brake on the heel piece (B)

■ (fig. 2) From the front, slide backward (A) the complete heel piece and readjust the heel piece's position (B).

■ (fig. 3) Turn the screw (A) and remove forward the heel piece from the rear plate (B)

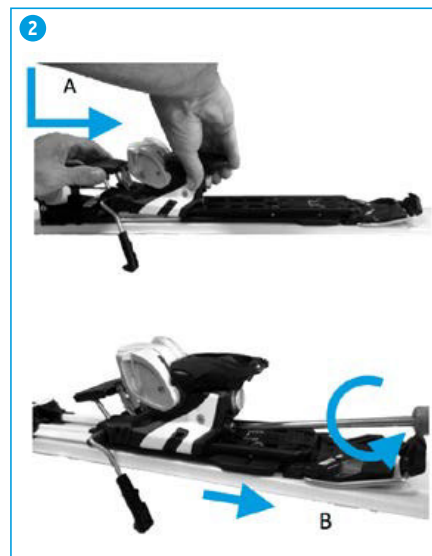
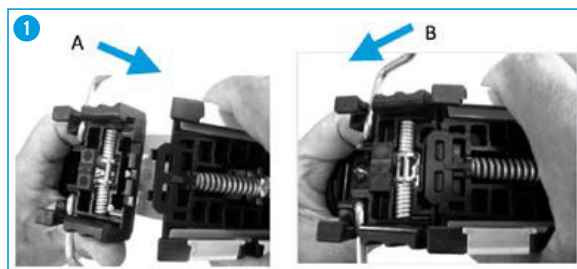

7. Press the heel to lock in the step-in

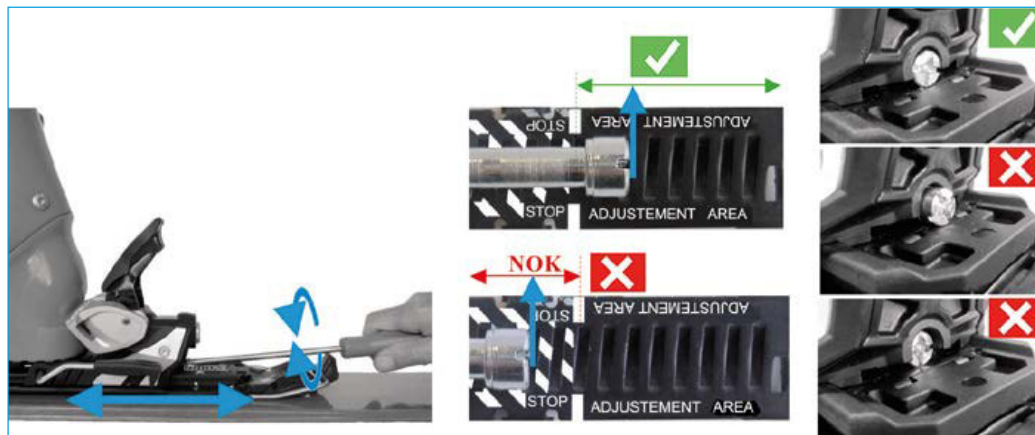

8. Step in the boot and adjust the heel piece's position with a screwdriver and check forward pressure

9. Adjust the boot toe's height by turning the adjustment screw to create a gap between the boot sole and the binding

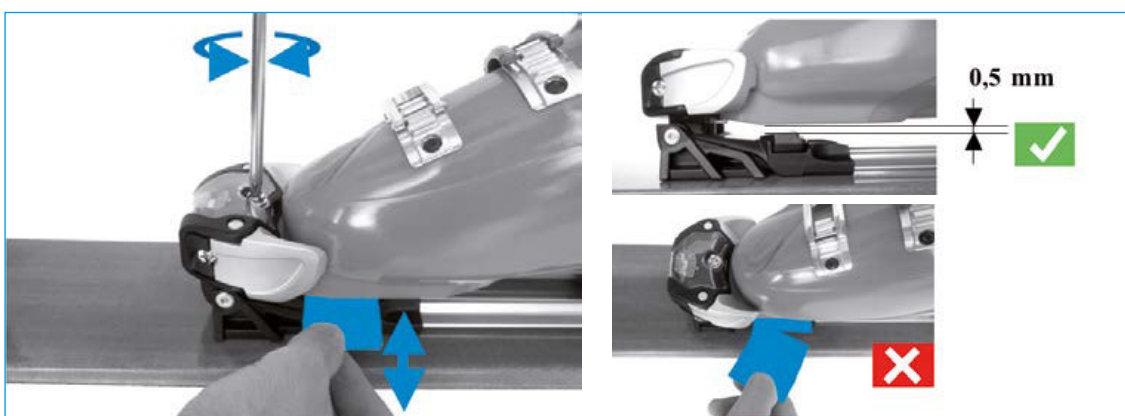

10. In case of adjustment with touring boots compliant with ISO 9523 standard, paste sticker on each ski

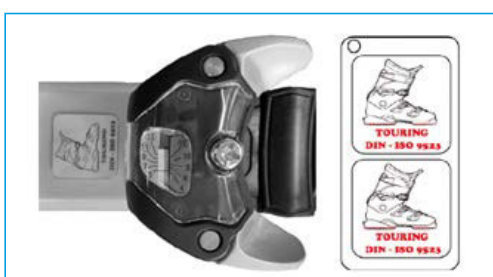

>>>

>>>

HIKING MODE

SWITCH FROM SKIING TO HIKING POSITION

1 - Use the ski pole to push backward the step in, lift the ski boot, and flip forward the hiking aid.



2 - Hiking aid can be set in 2 positions :

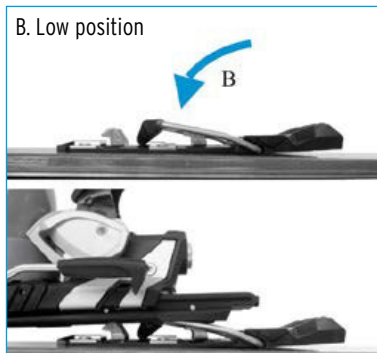

SWITCHING FROM HIKING TO SKIING POSITION

1 - The binding must be cleaned from snow, ice and dirt.

DO NOT put the hand between the ski and the binding when switching to skiing position

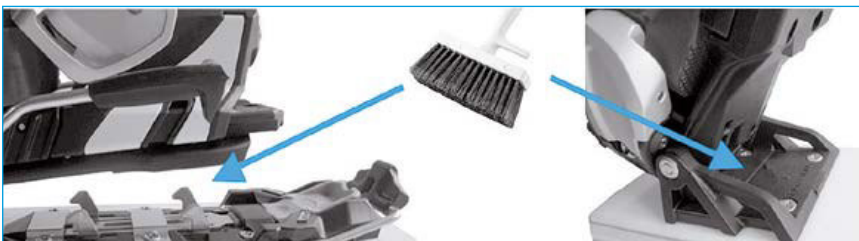

2 - Push back the climbing aid and lock down the binding heel piece

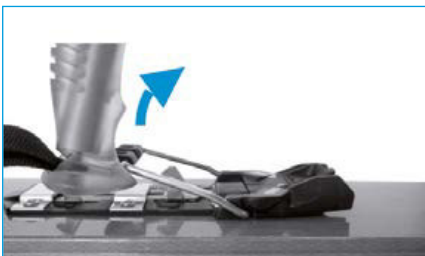

3 - Before skiing check that the binding is correctly locked in

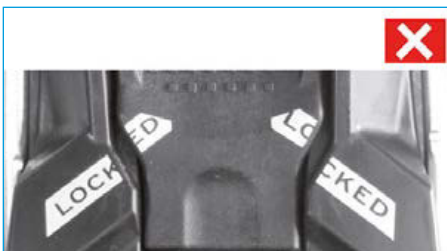
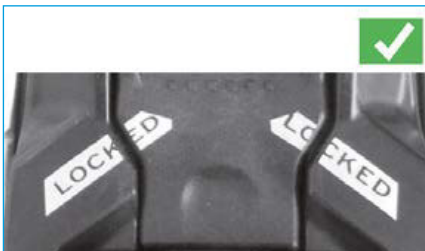

>>>

>>>

CRAMPON BACKCOUNTRY

Use the crampon which is adapted to the ski waist width.

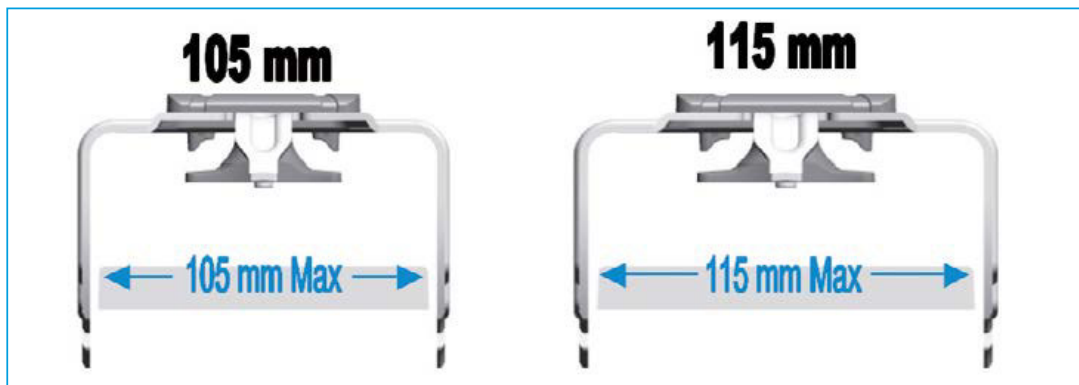

1 - Push backward the step in, lift the binding, and flip forward the hiking aid

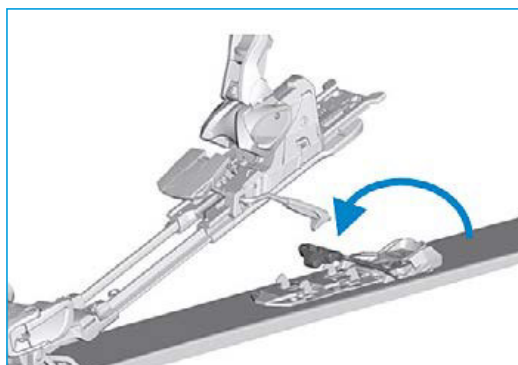
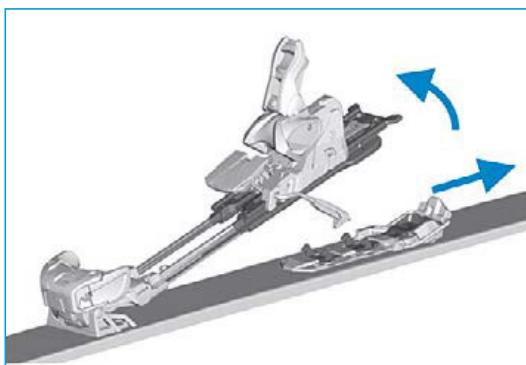

2 - Insert the crampon in the two lugs of the toe piece and lock the crampon

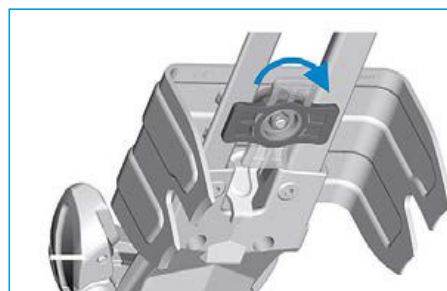
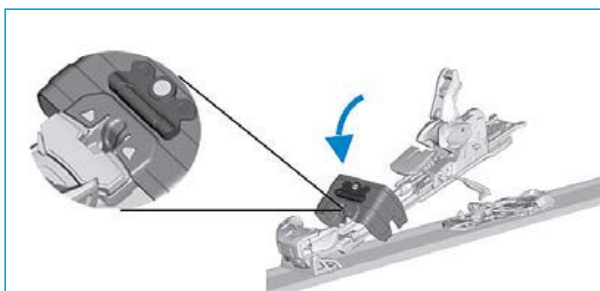

3 - Before using crampons **make sure that the hiking aid is in the low position. NEVER USING CRAMPONS IN THE HIGH POSITION**

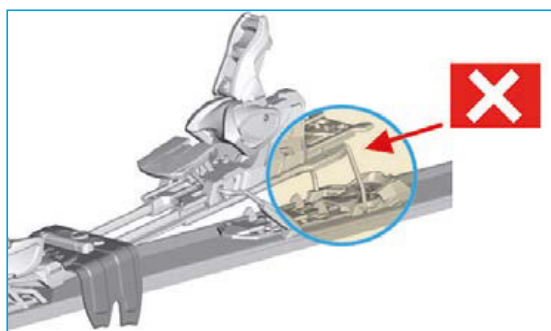
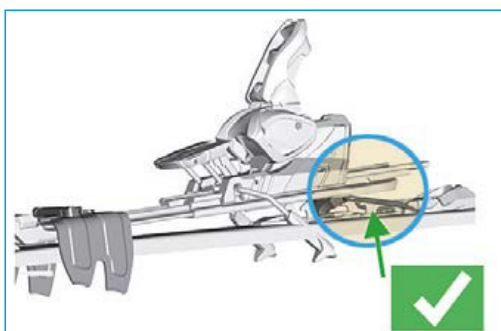

BINDING MODEL - SPECIFIC INSTRUCTIONS

STH2 BINDING « WTR » TECHNOLOGY

TO BE MOUNTED BY A SALOMON AUTHORIZED DEALER ONLY.



WARNING

THESE ALPINE BINDINGS ARE INTENDED TO BE USED ONLY WITH THE FOLLOWING SKI BOOTS:

- Alpine ski boots compliant with ISO 5355 standard

AND

- Ski boots equipped with « WTR technology » labelled kit of walking soles for touring skiing.

Any use with other ski boots could cause the ski-binding-boot system to be faulty and affect release characteristics, which would increase the risk of serious injury while skiing.

Therefore, skiers are warned not to use this product with any ski boots other than those meeting the standards indicated above. Skiers are advised to consult the dealer where this product was purchased, or an equipment specialist at any SALOMON authorized ski dealer of this product, for further information regarding which ski boots meet the standards listed above.

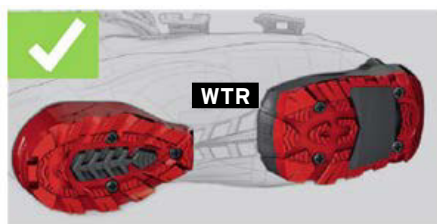
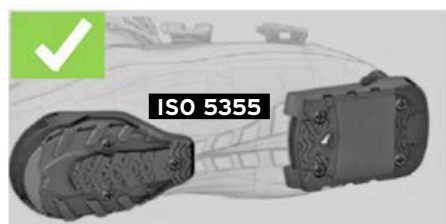

MOUNTING & ADJUSTING PROCEDURE

- 1 - Use the Salomon mounting jig (ref : 32981601) and drill the skis following the ski and binding manufacturer's instructions. Mount the toe piece and the rear plate on the ski by tightening the screws at 4 N.m (check if rear plate is correctly mounted).

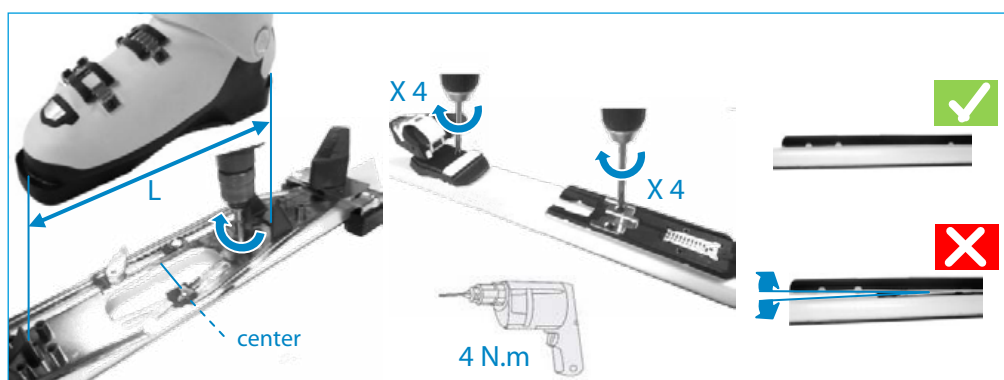

- 2 - Assemble the ski brake with the heel piece.



>>>

- 3 - From the center of ski, insert the heel piece on the rear plate and adjust at the "mid" position with a screwdriver.



- 4 - Step in the ski boot in the binding, check and adjust the forward pressure.



- 5 - Select and adjust the setting release values for toe and heel pieces.



- 6 - With the screw on the left side of the toe piece, adjust the toe wings to come in contact with the ski boot. (see § : ADJUSTING - WING ADJUSTMENT > p19).



- 7 - Adjust the toe height with the adjustment screw until to create a gap of 0,5 mm between the boot sole and the binding. (see § : ADJUSTING - TOE HEIGHT ADJUSTMENT > p19).

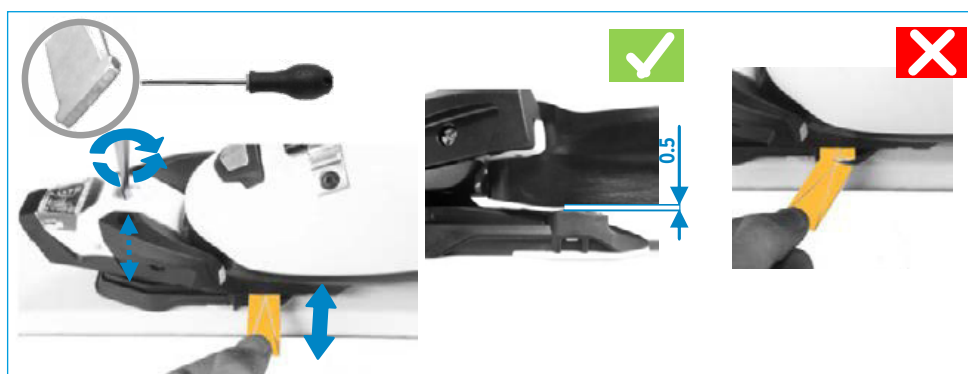

BINDING MODEL - SPECIFIC INSTRUCTIONS

MTN

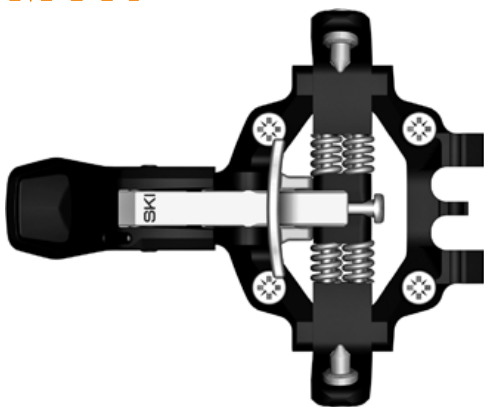

TO BE MOUNTED BY A SALOMON AUTHORIZED DEALER ONLY.

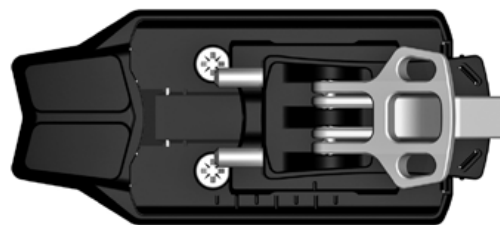

WARNING

These bindings are developed for extreme use and/or race only and do not comply with the requirements of DIN ISO 13992 standard. These bindings do not provide any systems for the release values adjustment but they supply a twist and forward release system. These bindings have been designed in order to be used with touring ski boot with inserts. The release can be highly affected by inserts and/or boot sole worn out. Furthermore, these bindings are not compatible with Folding boots such as Scarpa F1/F3/Tx.

BINDING DESCRIPTION

A - Toe

- 1- Locker
- 2- Step-in help
- 3- Toe pin
- 4- Crampon slot

B - Heel

- 5- Heel pin
- 6- Length adjustment screw
- 7- Climbing aid - low
- 8- Climbing aid - medium and high
- 9- Adjustment rail

C - Boot - Front

- 10- Insert

D - Boot - Rear

- 11- Insert

E - Accessory

- 12- Safety straps
- 13- Heel pin model

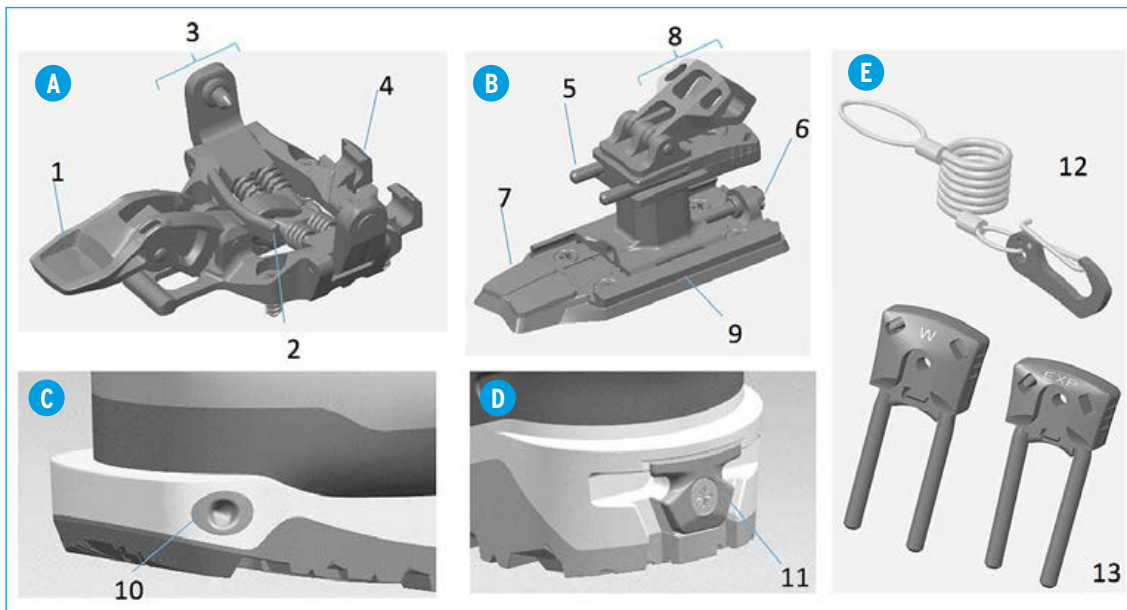

MOUNTING & ADJUSTING PROCEDURE

- 1- For mounting these bindings, holes must be drilled with Salomon mounting jig (ref L3816250001) to ensure a proper alignment of the binding. Put the boots on the jig and adjust the jig at boot length (boot rear insert in contact with the jig)



>>>

2- Mount the toe with the screws in the order below, but do not fully tighten the screws, so that the toe can still be move slightly (**fig. 2**).

3- Mount the heel with the screws in the order below (**fig. 3**).

4- Step-in the boot in the toe and put the "V" shape of the rear insert of boot between the binding heel pins (**fig. 4**).

5- Then fully tighten the two front screws on the toe (screw n°1 and 3) at the correct torque (**fig. 5**).

6- Tip over the boot in front direction and fully tighten the two rear screws on the toe (screw n° 2&4) at the correct torque (**fig. 6**).

7- Check to ensure that all screws are tight enough and that no screws are over tightened.

8- Use the safety straps snaplink supplied to check the gap between the boot and the heel (**fig. 8**).

9- Mount the safety straps on the toe (**fig. 9**).

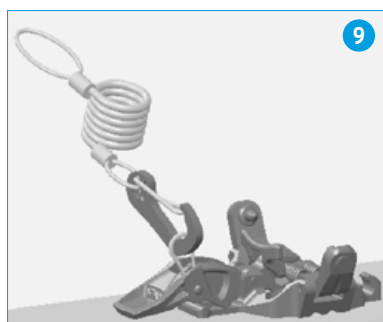
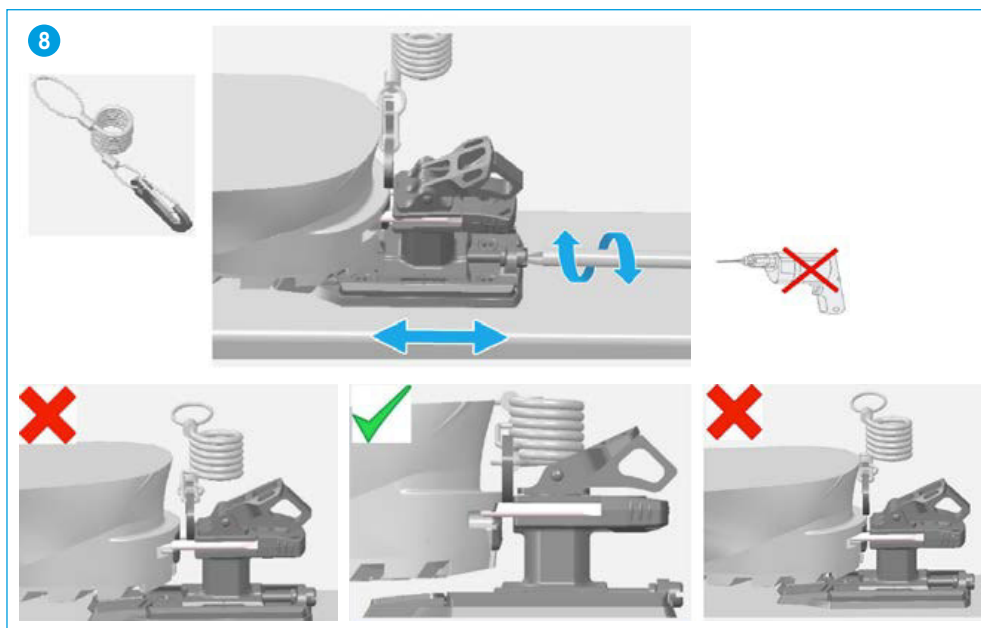
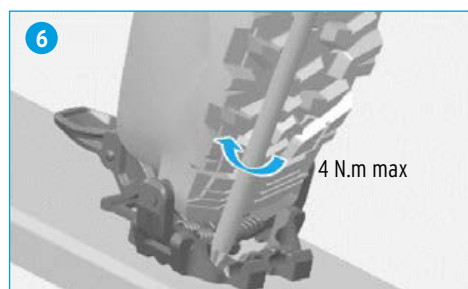
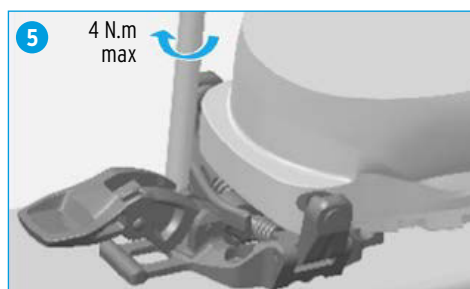
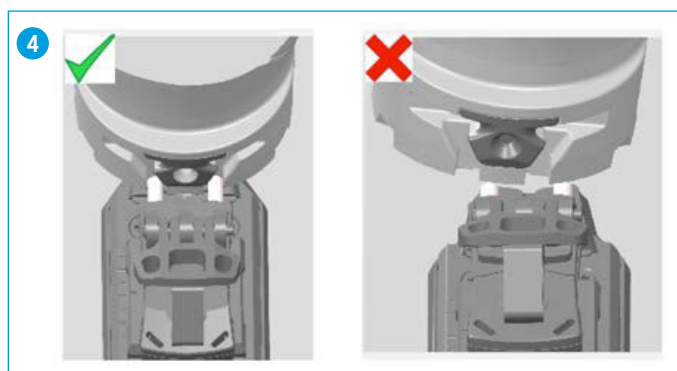
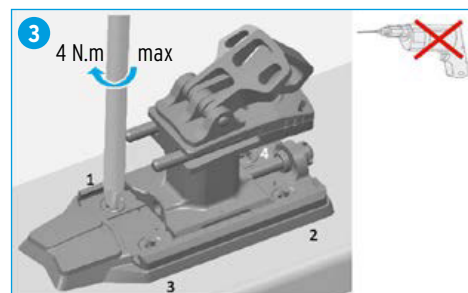
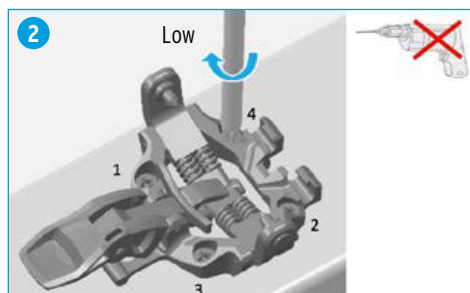

>>>

10- Heel PIN

The choice of the heel pin has to be determined by a dialogue between the skier and the authorized dealer, which helps to take into account the diverse factors that influence the choice.

These binding are delivered with "MEN" heel pin model assembled.



Heel pin model	W = WOMEN	MEN	EXP = EXPERT
Skier classification*	Type 1 or 2	Type 1 or 2	Type 3
	Increase capacity to release in a fall		Decrease capacity to release in a fall

* For more details, please, refer to chapter "skier classification" of this technical manual.

11- Heel PIN changing (fig. 11).

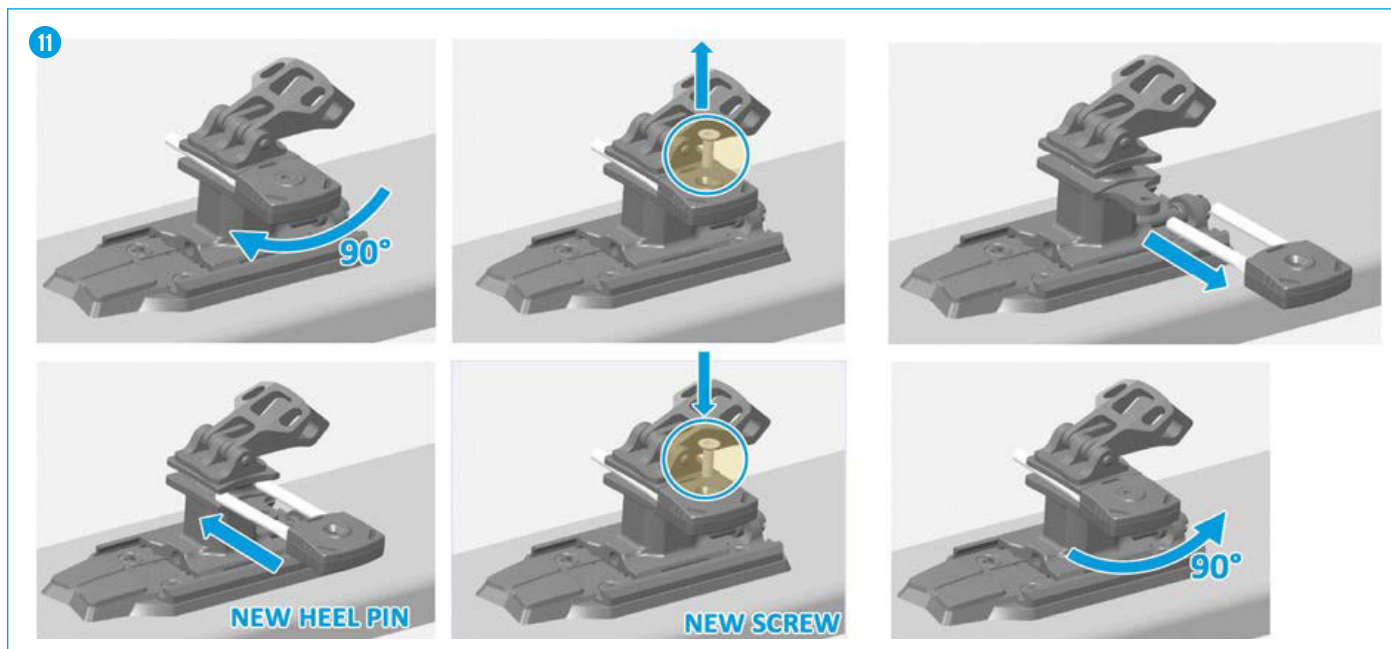

12- Lubrication points (fig. 12).

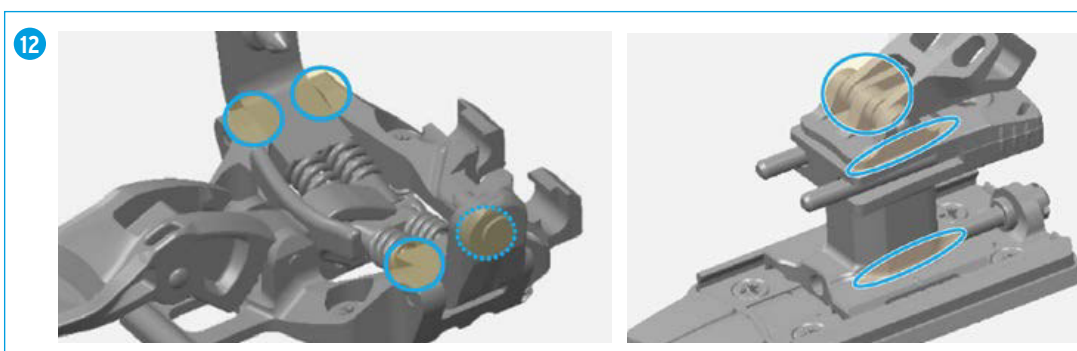

SKIER RECOMMENDATION

THE SKIER MUST BE INFORMED THAT:

- These bindings are developed for extreme use and /or racing.
- The skier uses these bindings under his responsibility and his own risk.
- The leaflet attached to the heel and remaining heel pins must be given to the skier.
- All adjustment on the binding (length adjustment, heel pin changing...) must be done by the authorized dealer only.
- These bindings are compatible with PLUM, Dynafit and ATK Crampons.
- Binding lubrication must be done regularly by the authorized dealer.

CLASSIFY YOURSELF

WHAT TYPE OF SKIER ARE YOU?

DETERMINING YOUR SKIER TYPE IS YOUR RESPONSABILITY

Your Skier Type, height, weight, age, and boot sole length are used by the shop technician to determine the release/retention settings for your bindings. Consult these descriptions to select your classification. Be sure to provide accurate information. Errors may increase risk of injury.



TYPE I

Cautious skiing on smooth slopes of gentle to moderate pitch

Skiers who designate themselves as Type I receive lower than average release/retention settings. This corresponds to an increased risk of inadvertent binding release in order to gain releasability in a fall. This type also applies to entry-level skiers uncertain of their classification.

SKIERS NOT
CLASSIFIED
AS TYPE I OR III

TYPE II

Skiers who designate themselves as Type II receive average release/retention settings appropriate for most recreational skiing.



TYPE III

Fast skiing on slopes of moderate to steep pitch

Skiers who designate themselves as Type III receive higher than average release/retention settings. This corresponds to decreased releasability in a fall in order to gain a decreased risk of inadvertent binding release.

This classification is not recommended for skier 47lb (21Kg) and under.

If from experience, you have been dissatisfied with the release/retention settings that result from your skier classification, mention this to your binding technician.

RELEASE SETTING ADJUSTMENT

CHART 1					CHART 2							
Mandatory Release values					Examples for Initial indicator value							
Skier's parameters			Inspection parameters		These are only the starting point in the binding setting process and may need to be modified in order to achieve the correct measured release value. Z (presetting), depending on boot sole length							
Skier's mass kg	Skier's height m	Skier code	Twist MZ N.m	Forward lean MY N.m	≤ 230 mm	231 mm to 250 mm	251 mm to 270 mm	271 mm to 290 mm	291 mm to 310 mm	311 mm to 330 mm	331 mm to 350 mm	≥ 351 mm
			5 ^a	18 ^a								
10 to 13		A	8	29	0,75	0,75	0,75					
14 to 17		B	11	40	1,0	0,75	0,75	0,75				
18 to 21		C	14	52	1,5	1,25	1,25	1,0				
22 to 25		D	17	64	2,0	1,75	1,5	1,5	1,25			
26 to 30		E	20	75	2,5	2,25	2,0	1,75	1,5	1,5		
31 to 35		F	23	87	3,0	2,75	2,5	2,25	2,0	1,75	1,75	
36 to 41		G	27	102		3,5	3,0	2,75	2,5	2,25	2,0	
42 to 48	≤ 1,48	H	31	120			3,5	3,0	3,0	2,75	2,5	
49 to 57	1,49 to 1,57	I	37	141			4,5	4,0	3,5	3,5	3,0	
58 to 66	1,58 to 1,66	J	43	165			5,5	5,0	4,5	4,0	3,5	3,0
67 to 78	1,67 to 1,78	K	50	194			6,5	6,0	5,5	5,0	4,5	4,0
79 to 94	1,79 to 1,94	L	58	229			7,5	7,0	6,5	6,0	5,5	5,0
≥ 95	≥ 1,95	M	67	271				8,5	8,0	7,0	6,5	6,0
		N	78	320				10,0	9,5	8,5	8,0	7,5
		O	91	380				11,5	11,0	10,0	9,5	9,0
			105	452						12,0	11,0	10,5
			121	520								
			137 ^b	588 ^b								

NOTE 1 For skiers of 13 kg and under, no further correction is appropriate. **NOTE 2** For skiers of 17 kg and under skier type - 1 is inappropriate.
a : Lowermost tolerance limit. - b : Uppermost tolerance limit.

ADJUSTMENT PROCEDURE

The release setting adjustment is obtained by using the adjustment cap or adjustment screws. The release setting is visible on the indicator. Adjust the toe piece and heel piece to the same settings. It is highly recommended to use a measuring device to check the release torque (see ISO 11088).

Release value selection and adjustment

The release settings must be used by the technician to determine the appropriate adjustment for each skier, which conforms to the following norms: ISO 11088, ASTM F 939, ASTM F 1063, and AFNOR FD S 52-448 (documentation fascicle).

SKIER CLASSIFICATION

This classification has to be determined by a dialogue between the skier and dealer, which helps to take into account the diverse factors that influence the adjustment. These factors are explained in the norms cited above.

► Type I skiers:

- Ski conservatively.
- Prefer slower speeds.
- Ski on easy to moderate slopes.
- Intermediate level, but not in good physical condition.
- Good skiers, smooth and supple style, emphasizing safety.
- Favor lower than average release/retention settings. This corresponds to an increased risk of inadvertent binding release in order to gain increased release capacity in a fall.

► Type II skiers:

- Intermediate skiers in good physical condition.
- Prefer a variety of speeds.
- Ski on varied terrain, including most difficult trails.
- All skiers who do not meet all the descriptions of the other skier types.

► Type III skiers:

- Ski aggressively.
- Normally ski at high speeds.
- Prefer moderate to steep terrain.
- Favor higher than average release/retention settings. This corresponds to decreased capability to release in a fall in order to decrease risk of inadvertent binding release.
- Type 3 settings should not be used by skiers of less than 22 kg.

OTHERS SKIERS TYPE

► Type I- skiers:

- Skiers looking for a lower release setting than type 1.
- Recommended for beginners over 25 years old.

► Type III+ skiers:

- Very strong skiers, on challenging terrain.
- Skiers looking for a higher release setting than type 3 skiers.

Skier type does not have the same meaning as skier ability. For instance, an advanced skier who skis all-terrain, but is not particularly aggressive, may be able to use Type 2 settings.

ADJUSTMENT PROCEDURE

1. Find the skier's code in [chart 1](#).

Locate the skier's weight in the first column and the skier's height in the second column. If the skier's weight and height are not on the same row, select the skier's code on the highest row.

2. This skier code is appropriate for Type 1 skiers.

For Type I- skiers: move up one row.

For Type II skiers: move down one row towards the bottom of the chart.

For Type III skiers: move down two rows on the chart.

For Type III+ skiers: move down three rows on the chart.

3. For skiers who are 50 years or older, or under 10 years: move up one row on the chart.

- For skiers weight 13 Kg and under, no further correction is appropriated.

- For skiers weight 17 Kg and under, type 1- skier is inappropriate.

4. After having determined the skier code, locate the column in [chart 2](#) that represents the skier's boot sole length (in mm).

5. The box at the intersection of the skier's boot sole length column and the skier's code row, shows the initial indicator setting for the skier. Adjust both toe pieces and heel pieces accordingly.

6. Caution: If the box at the intersection of the skier's boot sole length column and the skier's code row is empty, move horizontally on the same row and use the closest indicator setting.

7. If it is obvious that the bindings release inadvertently (unnecessarily), at the request of the skier, the dealer can:

- At first, increase the level in the forward fall, that is, on the heel piece.

- Then, only if the inadvertent releases persist, increase the level in torsion, that is, on the toe piece. Proceed very progressively in stages of half-points.

BINDING FINAL CHECKING AND VISUAL INSPECTION

A Salomon certified technician must sign or initial the Workshop form indicating that all systems inspections have been performed.

A final check is your quality control measure to verify that all required procedures have been properly completed and involves the following steps:

1. Visual inspection of system components.
2. Test for elastic travel and return.
3. Release value within specified range and boot-binding compatibility.

VISUAL INSPECTION OF SYSTEM COMPONENTS TROUBLESHOOTING PROCEDURE

After the bindings have been properly mounted and adjusted, visually inspect the ski/boot/binding system.

► The boot:

Check:

- for gross irregularities where the boot contacts the binding and the AFD (deformation, wear,...),
- that the boot conforms to the norm (DIN, ISO or ASTM markings).

If the boots are not marked, check with the supplier.

These bindings are not designed to function with boots that do not conform to the norm.

- that the boot has not started to crack or break.

The boot toe

Check for the absence of:

- rubber and/or metal tip protectors
- mold flashings
- a ramp or bevel in front of the AFD area
- grid pattern or tread in the AFD area
- excessive wear
- a toe sole extension with corner radius of less than 7 mm
- asymmetrical shape of the toe sole.

The boot heel

Check for:

- debris lodged in the sole
- scraped or improperly canted boot sole
- cut-outs in the heel sole that catch on the entry pedal
- cut-outs in the sole that impede proper brake function.

Note: If you are uncertain of boot compatibility, perform the 'Clean vs Lubricated' test. Boots that fail this test or violate any of the above points should not be used with any Salomon binding.

► The ski:

Check for:

- mounting screws protruding through the base
- delaminated sidewall. This can be detected by running your fingers along the sides of the ski.
- base plate flush with ski surface
- delaminated topskin
- pre-drilled holes. Bindings should not be installed on skis that have already been drilled for three or more sets of bindings.

► The binding:

The toe piece

Check for:

- stripped, loose or missing screws
- condition and location of the AFD (ripped, loose, imbedded dirt, boot sole pattern, tread imprint, etc)
- condition of anti-friction inserts (where applicable)
- missing or unreadable adjustment indicators and missing windows
- bent or broken base plate, principal axis or housing
- stripped or jammed toe height and cup adjustment screws
- jammed release adjustment
- other visible wear.

The heel piece

Check for:

- stripped, loose or missing screws
- improperly installed brake
- defective heel track
- bent or broken base plate, track or heel guide
- missing Delrin inserts in the heel guide
- jammed release adjustment
- unreadable indicators
- other visible wear.

The ski brake

Check for:

- improper installation
 - broken entry pedals
 - bent brakearms
 - strength of ski brake
- A brake must not compress totally when the ski is set on a flat surface.
- other visible wear
 - proper position of brakes
- They shouldn't touch the ski while they are functioning (especially on fat skis).

The complete system

Place the boot in the binding and check the accuracy of:

- toe height adjustment (if applicable)
- toe cup width adjustment (if applicable)
- forward pressure adjustment
- release adjustment settings
- symmetrical mounting of bindings to ski center line (+/- 1 mm)

This should be in the same location on both skis.

If you discover a correctable problem, repair the problem and re-test.

If the system still falls outside the "in-Use range", perform the 'Clean vs Lubricated' test.

TEST FOR ELASTIC TRAVEL AND RETURN

► Laterally (fig. 1):

Secure the ski. Hit the forefoot area of the boot with a rubber hammer. Use sufficient force to move the boot off-center, but not hard enough to release the system.

The boot should move off-center at least 5 mm and return to center within 2 mm of its original position.

► Vertically (fig. 2):

Put the boot in the binding, depress the heel lever while pulling forward on the upper cuff of the boot until the boot heel lifts at least 5 mm. Release both hands simultaneously. The boot should go back in place quickly and smoothly.

This check can be performed either manually or by using a mechanical device. If a measuring device is used, follow the recommendations of the test device manufacturer for proper procedure.



RELEASE VALUE WITHIN SPECIFIED RANGE AND BOOT/BINDING COMPATIBILITY



1

Testing of release values with a test device is recommended (fig. 1).

If a test device is not used, the skier should be informed.

In addition, the skier must be warned about the risk of possible breakage of boots and bindings that have been subjected to shocks or abnormal stress.

› Test the toe:

First, exercise the toe by releasing it once in each direction.

Then, using test device, measure and record the twist release value in each direction. The measured release value should be considered to be the middle quantitative value of three measured releases.

If the first two measured values are the same, there is no need to take a third measurement. See examples of middle quantitative values (Chart. 1).

The toe passes this inspection if the middle quantitative values in both directions fall within the 'Inspection range'.

See sample "System inspection ranges" (Chart. 2).

Symmetry test note

You should be aware of the possibility of an asymmetric release.

If your tested values for clockwise and counter-clockwise release appear to be at opposite extremes of the inspection range, you may have an installation error or incompatible boot.

Troubleshoot the system and re-test after the problem has been corrected.

› Test the heel:

First, exercise the heel by releasing it once. Using a test device, measure and record the heel release value.

The middle quantitative value of three heel releases should fall within the +/- 15% "inspection range".

› Release value verification - failure:

When the technician is satisfied that all required procedures have been completed according to Salomon's recommendations in this manual, he or she must sign the Workshop Form. (The signing technician must currently be certified by Salomon.)

Note: During manufacturing, Salomon precision tests every binding up to 5 times to assure that it functions properly and is calibrated correctly. It is extremely rare that a new component would be out of calibration unless there is damage.

› Troubleshooting:

Boot/binding systems wear with time. Mechanical inspection allows you to identify when the ski/boot/binding system is not working as it was originally intended. Readjustment of the binding is not a sign of malfunction, but can be a sign of normal wear.

› Test for lateral travel - failure:

Re-check all binding-to-boot adjustments.

Re-inspect the boot and the binding according to the Visual Inspection criteria. If the boot is dirty, clean the sole with a solution of soap and water.

If the binding is dirty, clean it according to the procedures described in this chapter under 'Maintenance'.

Re-test the system for elastic travel and return.

› Test for vertical elastic travel - failure:

Clean the boot sole of any snow, dirt or debris. Check for excessive wear at the boot heel. Repair or replace any non-DIN boot.

Check that the boot enters the binding correctly. Align the boot with toe and heel cups and re-insert the boot. Check the release setting. It should not exceed the minimum or maximum visual indicator setting and should be set appropriately for the skier.

If the measured +/- Mz and My values are located outside of the +/- 15% inspection range, consult the manufacturer's instructions for procedures concerning malfunctions.

If after this procedure, the measured values are within the readjustment range of +/-30%, the binding can be readjusted.

These readjustments should allow you to obtain measured values as close as possible to the selected individual release torque within the +/- 15% range.

If the release is still outside the +/- 30% readjustment range after having followed the procedures for malfunctions, do not readjust the binding unless it is specifically authorized by the manufacturer (chart. 1).

Chart. 1	
Three release values	Middle quantitative value
45 - 40 - 50	45
60 - 50 - 50	50
30 - 40 - 50	40
55 - 65 - 60	60

Chart. 2 - System inspection ranges

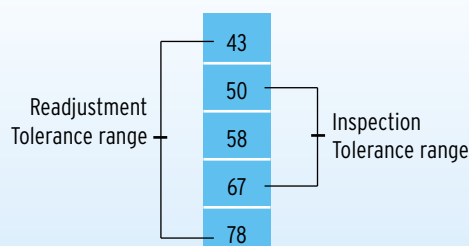

BOOT/BINDING COMPATIBILITY DIAGNOSIS

Clean vs lubricated test

1. Determine the measured release value in the ski/ boot/binding system without lubricant.
2. Determine the measured release value in the ski/ boot/binding system after lubricating all contact points between the boot and binding with a lubricant specified by the manufacturer. If nothing particular is specified, use soap and water.
3. Calculate the ratio between the two tests by dividing the result with the lubricant by the result without it.
4. If the quotient is above 1.2 or under 0.8, the system is considered to be incompatible. If the boot test result is a satisfactory +/- 30%, but the binding does not release within the 'readjustment tolerance' range, check the calibration of the adjustment machine. Have another technician redo the test. If the system still falls outside the range, the binding should not be used.

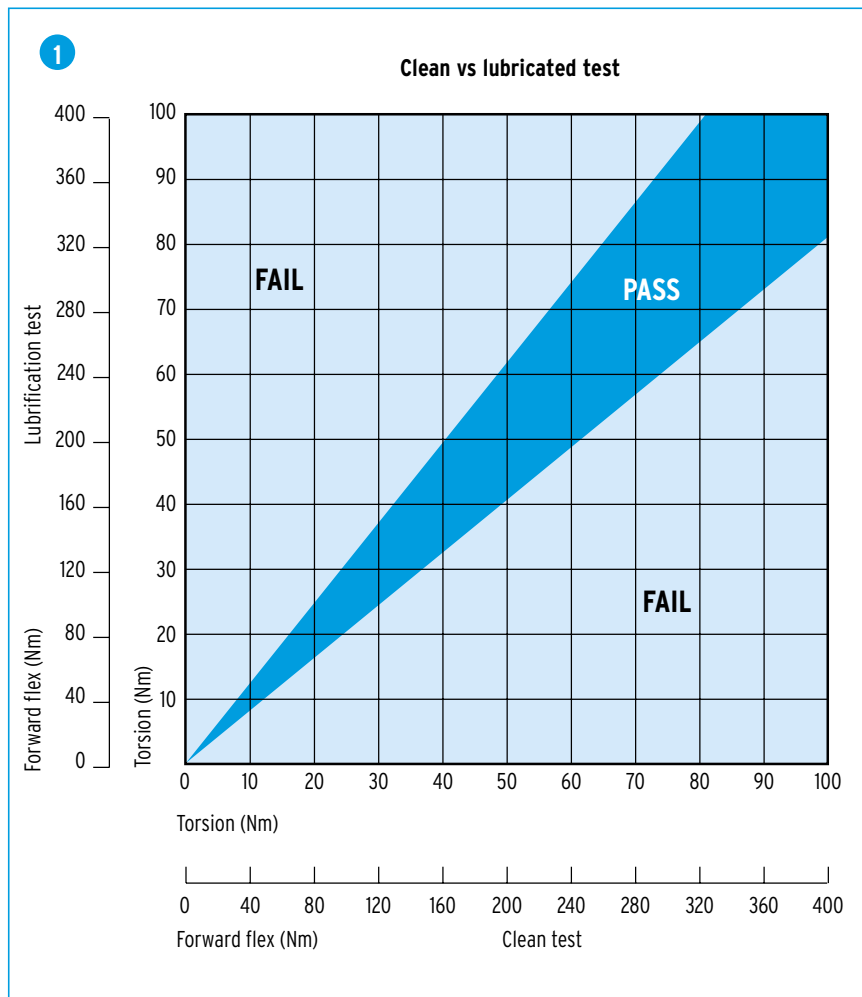

RETAIL SKIER INSTRUCTION AND WARNING

In principle an adjustment report is established by the ski shop and delivered to the user.

It shall at least contain the following information:

- skier's parameters,
- indicator value,
- measured value of Mz and My, or pass/fail result of the system test.

The exact content of the report and its delivery conditions are defined by the national standard organizations 11088.

› Explanation of entry/exit/re-entry:

The proper use of the system (entry, exit and re-entry) should be explained using the skier's own system as an example.

› Explanation of backcountry instructions

The transition of walking mode to skiing mode in case of backcountry binding should be explained using the skier's own system as an example.

› Receipt of in-box instructions and warranty:

When a skier purchases a new binding, it is required that s(he) also receive the instructional pamphlet included in each binding box.

NOTICE À REMETTRE AU SKIEUR
 BEDIENTUNGSANLEITUNG FÜR SKIFAHRER
 DENNE VEJLEDNING SKAL UDLEVERES TIL SKILØBEREN
 INSTRUCCIONES PARA ENTREGAR AL ESQUIADOR
 ΟΔΗΓΙΕΣ ΓΙΑ ΤΟΥΣ ΣΚΙΕΡ
 INSTRUCTIONS FOR ISSUE TO SKIERS
 FOLGIO INFORMATIVO DA CONSEGNARE ALLO SCIATORE
 HANDLEIDING VOOR DE SKIËR
 FOLHETO INFORMATIVO DESTINADO AO ESQUIADOR
 INSTRUKTIONER FÖR GER SKIDÅKAREN
 SUUSATAJALE MÖELDUD TEATIS
 A SÍELÓNEK ÁTADANDÓ ÚTMUTATÓ
 PAZIŅOJUMS, KAS NODODAMS SLĒPOTĀJAM
 SLIDININKUI SKIRTAS INFORMACINIS LAPĒLIS
 INSTRUKCJA DLA NARCIARZA
 NÁVOD PRO LYŽÁŘE
 NÁVOD PRE LYŽIARA
 VEILEDNING SOM GIS SKIKJØREREN
 ИНСТРУКЦИЯ ДЛЯ ЛЫЖНИКА
 ИНФОРМАЦИЯ ЗА СКИОРА
 KAYAKÇILARA VERİLECEK TALIMAT
 TIEDOTE HIIHTÄJILLE
 INSTRUCȚIUNI DE ÎNMÂNAT SCHIORULUI
 ПОВІДОМЛЕННЯ ДЛЯ ЛИЖНИКА
 スキーヤーへの注意書き
 滑雪者専用説明書
 스키어 사고 방지 지침
 UPUTSTVO KOJE TREBA DA SE URUCI SKIJAU



salomon 

INSPECTION

AID FOR APPLICATION OF ISO 13993 concerning

- rental ski shop practice
- sampling and inspection of complete and incomplete alpine ski-binding-boot systems in rental applications (this supplement does not replace ISO 13993).

To keep your rental equipment in good condition while minimizing liability we recommend the following program (this comes out of the ISO 13993 standard).

RENTAL INSPECTION SUMMARY

Since it is impractical to perform a full inspection each time a system is rented, a routine of preseason and inseason inspections has been developed to verify release indicator accuracy, confirm correct equipment function, and assure proper assembly and adjustment procedures by the rental shop staff.

Fully implemented, the procedures that follow provide rental shop customers a standard of care equivalent to that provided retail shop customers under current ISO and ASTM standards.

PRESEASON INSPECTION

Preseason inspections are performed on components of the release system: bindings and boots.

All rental bindings, new and used, are visually inspected, and then tested using specially selected Reference Boots.

Bindings that fail go through a troubleshooting procedure to identify and correct the deviation or malfunction.

If this procedure does not correct the problem, the binding is removed from inventory.

All rental boots, new and used, are visually inspected for damage, wear, contamination, broken or missing parts, or inferior materials at contact points with the binding.

In addition, one boot per 'cell' is tested for boots that are new to the rental inventory.

A cell is all boots of the same make, model, age, and shell size.

A random selection of 5% of all boots, previously accepted into inventory, is also tested.

Tests are performed with a test device and a pair of specially selected reference bindings.

If a boot fails, all boots from that cell are then tested. Boots that fail and cannot be repaired are removed from inventory.

INSEASON INSPECTION

Inseason inspections are performed on complete rental systems to ensure that the equipment is adjusted appropriately and continues to function correctly.

Typically 5% of the rental inventory is tested during each two weeks sampling period.

The random sample is equally divided between equipment that is available for rental and equipment that has just been rented.

The equipment in the 'as rented' category is from real skiers in the condition in which it is either dispatched or returned, while the 'available for rental' equipment may be set up for fictitious skiers.

Only single skis, not pairs, are tested, and testing at the toe is only required in one direction.

A count is maintained of test results which exceed allowable limits.

The magnitude and frequency of these deviations determines the frequency of future inspections.

Shops which fail an inspection must sample daily until the source of the problem is found and corrected.

Then, as inspection results improve, the frequency of sampling and inspection is relaxed.

INSPECTION PROCEDURES

IMPORTANT TERMS

CORRECTION FACTOR

The value that must be added or subtracted from the initial visual indicator setting to bring the test result within the Inspection Tolerance (or Inspection Range).

DIRECTIONS OF RELEASE

Unless otherwise specified (see Inseason Inspection), the directions of release to be tested are forward lean and clockwise and counterclockwise in twist.

TEST DEVICE

A device which meets ISO standard 11110 (or ASTM standard F1061) and has been checked and maintained in the manner specified by the device manufacturer.

TEST RESULT OR RELEASE TORQUE

The middle quantitative value of three tests made in the same direction.

(Add other terms from ISO 13993 or ASTM F1064 that are not defined elsewhere in the tech manual).

PRESEASON TEST

REFERENCE BOOT SELECTION

The Reference Boot is a boot of a designated sole length which is otherwise typical of the boot inventory.

Use the procedure below if the boot inventory includes several models and a representative boot can not be easily identified.

1. Select five single boots with sole lengths as specified in [Chart A](#) for the binding type to be tested: adult, junior, or child.
2. Clean all five boots with a mild detergent and water.
3. Adjust a rental binding to the release indicator setting specified in [Chart A](#) for the binding type.
4. Fit the binding to the boots and determine the Release Torque in all three directions of

release (forward lean and both directions in twist- three releases in each direction).

5. Average the Release Torque for CW and CCW twist release.
6. Reject and replace any boot with a CW to CCW difference of more than 6 Nm for adult boots or 4 Nm when testing child boot types.
7. Rank the five twist results and select as the Reference Boot for twist, the middle boot.
8. Rank the five forward lean results and select as the Reference Boot for forward lean, the middle boot.

PRESEASON BINDING INSPECTION

The procedure that follows is an integral part of preseason maintenance.

It is also a good way to determine if maintenance is adequate and which units have outlived their usefulness and must be removed from inventory.

1. Clean areas of the bindings that contact the boot and perform all preseason binding maintenance.
2. Visually or manually check:
 - a. AFD condition.
 - b. Brakes function.
 - c. Release indicator readability and travel.
 - d. Screw tightness.
 - e. (other product specific inspections if required)
3. Fit each binding to the Reference Boot and adjust the release indicators to the value in [Chart A](#).
4. Check that the heel track and toe track code (if any) agree with the sole length code (if any) of the Reference Boot.
5. With the Reference Boot in the binding, verify elastic travel of the toe piece by striking the boot toe with a mallet or dead hammer and checking that the toe piece returns the boot quickly and completely to center.
6. Verify elastic travel of the heel piece by lifting the boot while depressing the heel

piece cocking lever and checking that the heel piece returns the boot quickly and completely to the latched position. (other product specific procedures if required).

7. Manually release the binding 3 times in each direction.
8. Lubricate all boot/binding interfaces with a mild liquid detergent and water solution.
9. With the Ski Binding Test Device determine the Release Torque for each direction of release (forward lean and both directions in twist).
10. Record "PASS" in the binding's maintenance record if Test Results are within the Inspection Ranges provided in [Chart A](#).
11. Set the ski aside if the Test Result in any directions of release is outside the Inspection Range in [Chart A](#).
12. Follow Troubleshooting Procedure for units which have been set aside and retest if changes in the unit's condition or adjustment are made.
13. Record "FAIL" in the binding's maintenance record if, after troubleshooting, test results in any direction of release are outside the In-Use Range. Replace the 'failed' unit and retest before returning the ski to service.
14. If after troubleshooting, Test Results are outside the Inspection Range but within the In-Use Range, apply a Correction Factor to the unit and note the Correction Factor for that unit in the binding's maintenance record.
15. If many bindings fail, check the test device and re-inspect the Reference Boot.

If necessary, select another boot and retest the bindings.

Chart A: Preseason Binding Inspection

Skier code	Binding type	Sole length mm	Release indicator setting	Reference torque twist Nm	Reference torque forward Nm	Twist inspection range Nm	Forward inspection range Nm	Twist in-use range Nm	Forward in-use range Nm
E	Children	258	2.0	20	75	17-23	64-87	14-27	52-102
J	Junior	306	4.3	43	165	37-50	141-194	31-58	120-229
L	Adult	327	5.8	58	229	50-67	194-271	43-78	165-320

BINDING RENTAL - SPECIFIC INSTRUCTIONS

PRESEASON BOOT PREPARATION

The procedure that follows is an integral part of preseason maintenance.

1. Clean all boots with (a mild detergent and water), and repair or replace damaged or missing parts.
2. Visually check:
 - a. Conformance with ISO and other applicable standards. If the boot contacts the binding, brake, or AFD in areas other than the designated contact points, it may be incompatible with the binding (product specific figure or description).
 - b. Boot material. If the sole at the contact points with the binding or AFD can be scratched with a finger nail, the boot may be of inferior quality and incompatible with the binding.
 - c. Boot sole condition. If the boot sole is damaged, worn, or contaminated at contact points with the binding or AFD in a manner which can not be corrected, the boot may be incompatible with the binding.
 - d. Brake compatibility with sole.
 - e. Rubber and/or metal sole protectors. If such materials contact the binding or AFD the boot may be incompatible with the binding.
 - f. Mold flashings. Flashing which can be seen or felt at contact points with the binding, brake, or AFD must be carefully removed.
3. Remove from inventory all boots that have failed the visual check.

PRESEASON BOOT SAMPLING

Although sampling eliminates the need to test every boot before the season starts, the sample chosen must be representative of the inventory.

1. For boots that are new to inventory or have never been inspected, take a single boot from each cell (a cell is all boots of the same make, model, year, and shell size).
2. For used boots, take a 5% (but not less than 16 or more than 80) random sample of the entire inventory. Make sure that there is at least one boot from each cell in the sample.

PRESEASON BOOT INSPECTION

The procedure that follows helps to assure both boot/binding compatibility and boot interchangeability.

Note: when using [Chart A](#), in the Boot Inspection procedure that follows, the Sole Length and Release Indicator Setting Columns should be ignored.

1. Randomly select a pair of bindings that have passed the preseason inspection from each binding type; adult, junior, child.
2. Lubricate all boot/binding contact points with a mild liquid detergent.
3. Without regard to whether the boot is new or used, sort the sample by sole type and length according to the 20 mm Sole Length Categories defined by binding adjustment chart (ISO 11088).
4. In each Sole Length Category rank the boots by sole length and select the middle boot.
5. In each Sole Length Category fit the appropriate reference bindings to this "typical" boot and adjust the two bindings to release as close as practical to the Reference Torque in [Chart A](#). Use the Reference Torque corresponding to Skier Code (L) for the Adult binding, (J) for the Junior binding, and (E) for the Child binding.
6. Rinse the lubricant from one binding and mark it "clean". Mark the other "lubricated".
7. Test each boot in the Sole Length Category with the clean Reference Binding and then the lubricated Reference Binding in both twist and forward lean (only one direction in twist is required for the clean binding).
8. Set aside any boots for which the lubricated Test Result is more than 20% less than the clean Test Result in the same direction of release or the lubricated Test Result in any direction of release is outside of the Inspection Range provided in [Chart A](#) for the Skier Code used to set up the Reference Binding (L, J, or E).
9. Repeat the Visual Check on all boots that have been set aside, correct any defects noted, and retest. Remove from inventory boots that fail the retest.
10. Check all other boots from the same cell (make, model, year, and shell size) as those that failed.

Note: On completion of the preseason inspection, clean the liquid detergent from the equipment (and lubricate the binding before returning it to service).

INSEASON SAMPLING AND INSPECTION

The Inseason Inspection is a test of complete systems and all the procedures used by the rental staff to assemble and adjust the system.

The program uses random samples of rental inventory taken at routine intervals. Any sampling program that gives every unit of

inventory the same chance as every other of being picked is valid.

SAMPLE FREQUENCY

Random sampling is conducted throughout the entire season. Frequency is as follows:

1. After 7 days of operation.
2. If the sample passes the next sampling is taken after another 7 days of operation.
3. If two consecutive samples pass, sampling frequency is increased to 14 days.
4. If a sample fails at any time, daily sampling is instituted until two consecutive samples pass, at which point weekly sampling resumes.

SAMPLE SIZE

Sample size is 5% of inventory but not less than 16 nor more than 80 units as noted in **Chart B**. Sample size is based on average daily output. If rental output drops below 50% of capacity over the sampling period, the sample size can be reduced proportionately.

INSEASON INSPECTION

1. Take a random sample of the rental inventory as determined by **Chart B**. Take half the sample from inventory as it is either rented or returned and the remainder from inventory available for rental.
2. Wipe the boot clean and cycle the boot/binding systems at least once in each direction.
3. Test sample units in Twist (one direction only) and Forward Lean.
4. Compare the Test Results with the Inspection Range for the appropriate Skier Code.

5. If the results are within the Inspection Range, the unit passes.
6. If the results are outside Inspection Range but within the In-Use Range, count the unit as a Class I Deviation.
7. If the results are outside the In-Use Range, count the unit as a Class II Deviation.
8. Check elastic travel and visually inspect the ski brake function, interface areas between boot and binding, including AFD, lug height adjustment (if appropriate), and forward pressure. Count any deficiencies as Class I Deviations.

9. If more than the maximum number of Class I Deviations given in **Chart B** are found in the sample, or a single Class II Deviation is detected the sample fails and daily sampling must be conducted until the problem which led to the failed sample is found and corrected. For Troubleshooting Procedures following a Failed Inseason Inspection.
10. Record the date the sample was tested, the number of units tested the number of Class I and Class II (or III) Deviations, whether the sample passed or failed and any actions taken. There is no need to record the identity of units tested or actual Test Results.

Chart B: Sample Size

Inventory Size	100	200	300	400	500	600	700	800	900
Sample Size Units	16	20	30	40	50	60	70	80	80
Maximum Class I Dev.	3	4	6	8	10	12	14	16	16

RENTAL SKIER INSTRUCTION AND WARNING

In principle an adjustment report is established by the ski shop and delivered to the user.

It shall at least contain the following information:

- skier's parameters,
- indicator value,
- measured value of Mz and My, or pass/fail result of the system test.

The exact content of the report and its delivery conditions are defined by the national standard organizations 11088.

Explanation of entry/exit/re-entry:

The proper use of the system (entry, exit and re-entry) should be explained using the skier's own system as an example.

Explanation of specific instructions

It is required that the dealer explains to the skier, specific instructions included in the instructional pamphlet (ex: transition of walking mode to skiing mode in case of backcountry binding...).

RETAIL GUIDELINES

Salomon bindings require a minimum of maintenance to enhance performance and their useful life. They should be cleaned, inspected and lubricated prior to each season and every 15-20 skier days per season as follows:

- Inspect all components of each set for damage or excessive wear.
- Repair or replace damaged or excessively worn parts and/or components.
- Clean the exposed areas of the components with a cloth or rag. Wipe any dirt or grit from the binding housings, heel track and the region under the heel cup. Do not use solvents or hot water or high pressure liquid cleaning systems to clean bindings.
Solvents may cause permanent damage to the plastic structure by dangerously modifying the product technical characteristics. The markings can also be erased.
- Apply Salomon grease to the lubrication points indicated for each model. Do not use silicone or penetrating oils unless the lubricant is specifically approved.
- Recommend to the skier that routine maintenance and inspections be performed by an Authorized Dealer. This will help ensure that any problem that may develop with the system can be detected and corrected by a trained technician.

RENTAL GUIDELINES

Proper maintenance of rental systems includes a complete inspection of the entire rental inventory prior to the ski season. Bindings should be cleaned, inspected and lubricated in the following manner:

- Inspect all components for damage or excessive wear. Repair or replace damaged or excessively worn parts and/or components.
- Remove the toe by sliding it off the front plate.
- Visually or manually check, the pedal, the locker working and screw tightness.
- Remove the heel by sliding the housing off the rear of the track.
- Visually or manually check, brakes function, locker working, screw tightness.
- Clean the exposed areas of the components with a cloth or rag. Wipe any dirt or grit from the binding housings, heel track and the region under the heel cup. Do not use solvents, hot water or high pressure liquid cleaning systems to clean bindings.
Solvent may cause permanent damage to the plastic structure by dangerously modifying the product technical characteristics. The markings can also be erased.
- Apply Salomon grease to the lubrication points indicated for the appropriate model. Do not use silicone or penetrating oils unless the lubricant is specifically approved.
- Slide the heel back on the track.
- The brake is removable to facilitate ski maintenance.
- This should be followed by periodic in-season inspections and when a binding looks particularly dirty or if visual inspection reveals that something may be wrong. This helps to ensure that all components are functioning correctly.

Never attempt to interchange any SR, SC or retail toe baseplates or heel tracks with other model baseplates or heel tracks.

RENTAL POST SEASON STORAGE

To prepare rental equipment for summer storage:

- All binding visual indicator adjustments should be reduced to the lowest setting. Do not attempt to adjust the release setting below the lowest setting as damage may result.
- The binding heels should be stored in the closed position.
- The equipment should be stored in a cool, dry and ventilated area away from direct sunlight.

BROKEN MOUNTING SCREW

Salomon screw extractor kit: it comes with two bits of different lengths.

The longer bit is for use with the Salomon jigs for adult skis.

The shorter bit should be used with the Salomon jigs for junior skis.

The procedures for using both bits are the same. When a screw or tap breaks in a ski, it must be removed carefully to avoid further damage.

Follow this procedure:

1. Fit the extractor drill bit into the electric drill with the shoulder touching the chuck.
2. Fasten the appropriate jig onto the ski.
3. Position the correct jig bushing directly over the broken screw.
4. Drill slowly around the broken screw using an up-and-down movement to let the shavings escape.
5. Continue until the chuck touches the bushing of the jig.

Caution: do not hit the screw.

6. The broken screw will come out inside the extractor bit.
7. Remove the screw using a pair of pliers.
8. Turn the ski over and tap lightly to remove all shavings.
9. Put a drop of glue into the hole.
10. Insert a plug from the kit using a hammer.
11. Insert binding screw and tighten using a hand driver. Do not over tighten.
12. When a hole simply needs to be widened to accept the plastic plugs, use an 8 mm diameter bit. Do not drill deeper than 10 mm.

STRIPPED SCREWS

For a stripped screw, use the repair kit 000878. For this operation, use the corresponding jig and position it properly by lining it up with the hole to be repaired.

When drilling, the drill bit must be perpendicular to the surface of the ski.

Make sure you don't go beyond the plug once it is in place. You can file it down to make it level with the surface.

MOBIL PLATE REPLACEMENT (SCP: Salomon Control Pedal)

All Salomon bindings have replaceable SCPs. The specific SCP item numbers can be found in the Salomon Spare Parts catalog.

Replacement procedures for SCPs are follows.

On Toes tighten on Interfaces and Skis

(SMARTRAK GRIP/GRIP PLUS - SC - ITF):

➤ 78830101 for Z14 - Z12 Ti - Z12 - Z12 Ti SC - Z10 Ti AXE+ - Z10 Ti - Z10 Fis 20 - Z10 Ti SC - Z10 - 710 Ti - 710 SC - 710 - 710 ITF.

1. Dismount the Toe piece from the Ski or the Interface by completely loosening the mounting screws.

2. Dismount manually the SCP on the Toe piece.
3. Take the new SCP and mount it manually under the Toe piece.
4. Tighten the Toe piece on the ski or the Interface (4Nm Torque).

On Toes SMARTRAK PROLINK/CONTROL/RESPONSE:

➤ 78829401 for SMARTRAK PROLINK + 914
 ➤ 78829501 for SMARTRAK PROLINK & SMARTRAK CONTROL + Z14 - Z12 - Z10 - 711
 ➤ 78829601 for SMARTRAK PROLINK & SMARTRAK CONTROL + Z12 Ti - Z10 Ti - 710 Ti.

1. Put the Toe Piece out the Interface.
2. Dismount the Toe piece from the Set by completely loosening the mounting screws.
3. Dismount manually the SCP+Stirrup on the Toe piece.
4. Take the new Set SCP+Stirrup and mount it manually under the Toe piece.
5. Tighten the Toe piece on the Stirrup (4Nm Torque).
6. Remount the Toe piece on the Interface.

JUNIOR T 5 & C 5 AND L 7-8-9-10 anti friction plate replacement

1. Insert a screwdriver width 6-8 mm at the front of the plate (fig. 1).
2. Move over the screwdriver to eject the plate (fig. 2).
3. Place the new plate and hand clip it (fig. 3 & 4).

Caution: for models with elastic pedal (range 08), check the presence of the elastic block under the pedal (fig. 5).

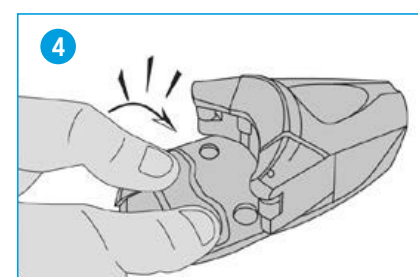
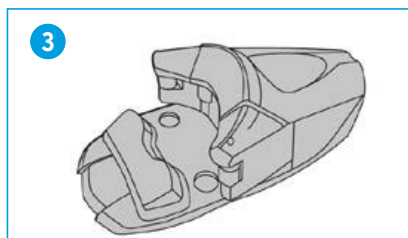
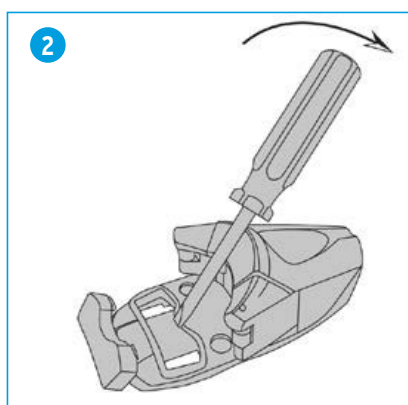
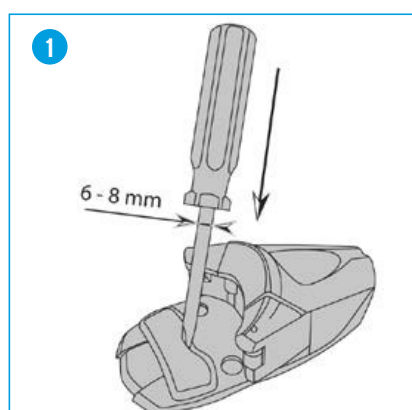

NOTES

Handwriting practice lines consisting of 20 horizontal dotted lines.

HEAD OFFICE

SALOMON S.A.

Siege social Metz-Tessy
F-74996 Annecy Cedex 9
Tel: 33 (0)4 50 65 41 41
Fax: 33 (0)4 50 65 42 56
33 450 65 42 57

SUBSIDIARIES DISTRIBUTORS

ARGENTINA

Winners Productos deportivos S.A.
Tel: +54 115 256 5000

AUSTRALIA

Tel: +61 3 8586 6666

AUSTRIA

Tel: +43 662/45 55 47 100

BELARUS

Sport Retail Project
+375 17 226 18 10

BRAZIL

Tel: +5511 3094 1923

BULGARIA

Mtk Sport
Tel: +359 888 343 427

CANADA

Tel: +1 905 470 9966

CHILE

Grylan S.A.
Tel: +562 949 37 17

CHINA

Tel: +862 168 755 010

CZECH REPUBLIC

Tel: +420 272 700 963

DENMARK

Tel: +45 45 565 530

ESTONIA, LATVIA, LITHUANIA

A. & Tova
Tel: +372 518 95 88

FINLAND

Tel: +358 207 789 600

FRANCE

Tel: +33 4 74 99 15 15

GEORGIA

DV Sport
Tel: +995 77 99 11 22

GERMANY

Tel: +49 (0) 8000/725 6666

GREAT BRITAIN

Tel: +44 1276 404 850

GREECE

Shop & Trade S.A
Tel: +30 210 3408400

HOLLAND

Tel: +31 334 345 070

HONG KONG

Orient Fair Development Ltd
Tel: +85 224 101 952

HUNGARY

Tel: +361 205 37 70

INDIA

Pantaloon Retail Ltd (Future Group)
Tel: +911 244 641 302

ISRAEL

Masai
Tel: +972 523 910 882

ITALY

Tel: +39 0422 52 91

JAPAN

Tel: +81 3 6831 2717

KAZAKHSTAN

UZBEKISTAN
Union Space
Tel: +998 71232 4440

KOREA

Tel: +822 518 0781

KYRGYZTAN

Gergert Sport
Tel: +996 772 545 610

LEBANON

Sports Experts
Tel: +961 37 72 555

MACEDONIA

Sport Life D.O.O.
Tel.: +389 2 3127 360

MALAYSIA

VGO Corporation. Ltd
Tel: +65 6543 5828

MAURITIUS

Amer Sports Export
Tel.: +49 89 89801 300

MEXICO

Tel: +52 55 9177 9175

MONGOLIA

Ayanchin
Tel: +976 11 31 92 11

NEW ZEALAND

Snoworld Sports
Tel: +64 3 366 11 22

NORWAY

Tel: +47 6755 1330

NEW-CALEDONIA

Ballande SAS
Tel: +687 28 78 39

PHILIPPINES

Uniglobe Travelware Co.,Inc
Tel: 63 2303 1234

POLAND

Tel: +48 126 145 200

REUNION ISLAND

Tel: +336 92 64 62 03

ROMANIA

Master Sport
Tel: +407 226 778 00

RUSSIA

Tel: +7 (495) 641 2646

SERBIA

Beosport
Tel: +381 63 10 52 289

SINGAPORE

VGO Corporation. Ltd
Tel: +65 6543 5828

SLOVAKIA

Tel: +421 244 640 011

SOUTH AFRICA

Trail Terrain
Tel: +27 82 33 13 005

SPAIN

Tel: +34 9326 25 100

SWEDEN

Tel: +46 33 233 700

SWITZERLAND

Tel: +41 41 784 26 26

TAIWAN

**Ting San Iou Mountain
Equipment Co Ltd**
Tel: +886 229 516 693

TURKEY

OCO Sport Ltd Sti
+90 212 265 11 41 144

UKRAINIA

Multi Sport
Tel: +380 979 719 968

UNITED ARAB EMIRATES

Nik General Trading
Tel: +971 43 59 87 80

USA

Tel: +1800 225 6850

USHUAIA

Popper S.A
Tel: +542 901 422 244

OTHER COUNTRIES

Tel: +33 450 65 41 41

Front cover: ©Christoffer Sjoström - Photos: Fabrik d'Images, Studio E. Bergoend, P. Toeroek, S. Deslandes, J.M. Favre, Scott Markewitz, J.L. Michon, C. O'Connell, Pentaphoto, Zoom - © SALOMON 2016. RCS Annecy B 325 820 751.
S.A. à Conseil d'Administration. This document is not contractual.
SALOMON reserves the right to modify or discontinue any product.
Every product not available in all countries. All rights reserved.